

## Broadband Map v5 Community and Provider Challenge Form

The Office of the Chief Information Officer ("OCIO" or "Office") recently published the Statewide Broadband Availability Map version 5 ("Map v5"). Map v5 is designed to facilitate decisions concerning future spending under federally-funded broadband programs. Because Map v5 does not use the tiered structure envisioned by Iowa Code chapter 8B and because future federally-funded grant opportunities made available by the Office in accordance with Map v5 will not conform to Iowa Code chapter 8B, the map challenge process envisioned under Iowa Code section 8B.10 does not apply. However, the Office is making available a challenge process to allow public input into whether the map accurately reflects broadband coverage as of the publication date of Map v5 (the "As Of" date of Map v5).

The Office utilizes maps and data sources made available by the Federal Communications Commission (FCC) and/or developed or produced by contractors or third parties retained or utilized by the Office. These maps and corresponding data sources represent the status of Broadband in Iowa on the As Of date as reported by Communication Service Providers in Iowa. Unlike prior broadband coverage maps, Map v5 identifies broadband coverage by individual locations, making Map v5 far more granular than prior maps that displayed eligibility at the census block level.

Challenges to Map v5 will be based on presence or reliability of service and/or speed. Challengers will be required to provide for every location challenged an address and corresponding IA Location ID, to the extent a Location ID is available on the map. Challenges without this information may not be evaluated.

Every location on Map v5 reflects a status of 'likely eligible' or 'likely ineligible.' This status is based solely on speed and technology type. The eligibility of any particular location is contingent on the requirements associated with the federal funding being used to fund future Notices of Funding Availability ("NOFAs"). Eligibility determinations are subject to change over time. In addition, eligibility designations in no way guarantee facilitation of service in the future through state- or federally-funded broadband builds.

On August 2, 2022, the Office posted the final version of Broadband Availability Map v5 and opened a 30-calendar-day challenge window wherein anyone aggrieved or adversely affected by mapping determinations may challenge the Office's final determination of whether service at a particular location is accurately reflected.

This form is for PROVIDERS and COMMUNITIES only. Resident challengers should fill out the form via the Map on the website.

You must check next to each row that you have read and understood the terms of the challenge process. Without this acknowledgment, the appeal will not be evaluated.

Use the tab titled "Challenge Form" to challenge any particular location. If you would like to report an address not presenting on the map, please use the tab titled "Location Not Present on Map." You can also use this tab to report when the location is not presenting at the correct area.

**Challenger acknowledges the following (click checkbox to acknowledge):**

<p>The information on the Map may be challenged for conditions existing as of August 2, 2022 (the "As Of" date). Challenges based on changes occurring to broadband service after the As Of date will not be considered.</p>		
<p>When submitting a challenge, evidence must be submitted for every location challenged in support of changing the likely eligible or likely ineligible status. Documentation that is speculative, generalized, or vague will not be sufficient. You may use the Sworn Statement/Survey template provided. Supporting documentation must be provided in one pdf. Reference to the page number of the supporting evidence within the pdf must be noted in Challenge Form. Challenged locations without a referenced page will not be evaluated.</p>		
<p>The Office reserves the right to reject challenges for a variety of reasons, including but not limited to:</p> <ul style="list-style-type: none"> <li>&gt;&gt; Challenges claiming buildout at a future date;</li> <li>&gt;&gt; Challenges received reflecting incomplete information, including lacking IA Location ID;</li> <li>&gt;&gt; Challenges to a provider's service that are submitted without supporting evidence;</li> <li>&gt;&gt; Multiple challenge forms submitted by a provider or a community;</li> <li>&gt;&gt; Challenges received after September 1, 2022;</li> <li>&gt;&gt; Challenges received without all checkboxes marked indicating acknowledgement of the terms.</li> </ul>		
<p>The Office will notify affected parties by posting to the website any notice of challenge received. Final agency decisions shall become final unless within 30 days of the posting of a final decision, a challenger or person or party aggrieved or adversely affected requests a contested case proceeding pursuant to Iowa Administrative Code chapter 129-6.</p>		



## Broadband Map V5 Provider/Community Challenge Form

### A. CHALLENGER INFORMATION

Entity/Community Name	Citizens Mutual Telephone Cooperative
FRN (Provider Only)	3733029
Address	114 W Jefferson St
City	Bloomfield
State	IA
Zip	52537

### B. DESIGNATED CONTACT INFORMATION

Contact Name	Vince Tyson
Contact Phone Number	641-664-2074
Contact Email	<a href="mailto:vtyson@mycmtech.com">vtyson@mycmtech.com</a>

### C. EXPLANATION

To the extent you believe additional explanation is required to ensure that you are communicating full and accurate information, please provide narrative to further explain your challenge.

Citizens Mutual believes the DSL rate and reach are overstated in rural areas for some locations outside our incumbent service area. Because we do not know the location of each and every DSL access node, we are challenging the locations we believe are highly unlikely to have DSL service at the speeds indicated. It is our hope the OCIO can request specific information for the DSL provider that either confirms or denies their ability to provide the speeds. The ability to provide the speed can easily be determined if the provider indicates the copper loop length from the address location to the serving DSL electronics node.

### D. ATTESTATION

By signing and submitting this form, the authorized representative attests that to the best of the authorized representatives knowledge and belief, the information submitted through this challenge form is true and accurate, and the form is signed under the pains and penalties of perjury. By typing your name, you are affixing your signature to this form and attesting to the accuracy of the information submitted herein.

Authorized Signature:

Title:

General Manager

Date:	9/2/2022			
-------	----------	--	--	--

IA Location (ID)	Street Address	City	State	Zip Code	No. of Units at address (house, multi-residential units)	Basis for Challenge	Challenge Detail	Fastest download speed in Mbps for this type of service (Enter 0-2000)	Fastest upload speed in Mbps for this type of service (Enter 0-2000)	Technology Type	Service Conditions The Map Should Reflect					Evidence:		
											Is this location served, underserved, or unserved?	Technology Type	Survey Statement/ Survey Response	Broadband study expressly citing location	Speed test at this location	Other	Enter the page number(s) in the cell below identifying the exact location of the proof in the PDF.	
99452	1137 LAKE ROAD	DRAKESVILLE	IA	52552	1	11-Provider not reflected on the map	Provider only: The Map does not correctly reflect service that I facilitate to this location	1000	1000	Fiber								2
634063	11016 FIR AVENUE	DRAKESVILLE	IA	52552	1	11-Provider not reflected on the map	Provider only: The Map does not correctly reflect service that I facilitate to this location	1000	1000	Fiber								3
441860	17211 42ND STREET	OTTUMWA	IA	52501	1	11-Provider not reflected on the map	Provider only: The Map does not correctly reflect service that I facilitate to this location	1000	1000	Fiber								4
618268	27553 CLAY AVENUE	BLOOMFIELD	IA	52537	1	11-Provider not reflected on the map	Provider only: The Map does not correctly reflect service that I facilitate to this location	1000	1000	Fiber								5
665905	10907 FIR AVENUE	DRAKESVILLE	IA	52552	1	11-Provider not reflected on the map	Provider only: The Map does not correctly reflect service that I facilitate to this location	1000	1000	Fiber								6
668089	19851 30TH STREET	BLAKESBURG	IA	52536	1	11-Provider not reflected on the map	Provider only: The Map does not correctly reflect service that I facilitate to this location	1000	1000	Fiber								7
891623	12105 280TH STREET	BLOOMFIELD	IA	52537	1	11-Provider not reflected on the map	Provider only: The Map does not correctly reflect service that I facilitate to this location	1000	1000	Fiber								8
110973	19146 30TH STREET	BLAKESBURG	IA	52536	1	11-Provider not reflected on the map	Provider only: The Map does not correctly reflect service that I facilitate to this location	1000	1000	Fiber								9
495790	18949 30TH STREET	OTTUMWA	IA	52501	1	11-Provider not reflected on the map	Provider only: The Map does not correctly reflect service that I facilitate to this location	1000	1000	Fiber								10
817299	1045 LAKE ROAD	DRAKESVILLE	IA	52552	1	11-Provider not reflected on the map	Provider only: The Map does not correctly reflect service that I facilitate to this location	1000	1000	Fiber								11
1088462	11398 152ND STREET	UNIONVILLE	IA	52594	1	11-Provider not reflected on the map	Provider only: The Map does not correctly reflect service that I facilitate to this location	1000	1000	Fiber								12
184274	32064 275TH STREET	PULASKI	IA	52570	1	11-Provider not reflected on the map	Provider only: The Map does not correctly reflect service that I facilitate to this location	1000	1000	Fiber								13
1158269	52118 275TH STREET	OTTUMWA	IA	52501	1	11-Provider not reflected on the map	Provider only: The Map does not correctly reflect service that I facilitate to this location	1000	1000	Fiber								14
64866	18859 30TH STREET	OTTUMWA	IA	52501	1	11-Provider not reflected on the map	Provider only: The Map does not correctly reflect service that I facilitate to this location	1000	1000	Fiber								15
357173	18281 30TH STREET	OTTUMWA	IA	52501	1	11-Provider not reflected on the map	Provider only: The Map does not correctly reflect service that I facilitate to this location	1000	1000	Fiber								16
790677	11075 ROUTE J40	MILTON	IA	52570	1	11-Provider not reflected on the map	Provider only: The Map does not correctly reflect service that I facilitate to this location	1000	1000	Fiber								17
460024	17505 42ND STREET	OTTUMWA	IA	52501	1	11-Provider not reflected on the map	Provider only: The Map does not correctly reflect service that I facilitate to this location	1000	1000	Fiber								18
596352	1240 LAKE ROAD	DRAKESVILLE	IA	52552	1	11-Provider not reflected on the map	Provider only: The Map does not correctly reflect service that I facilitate to this location	1000	1000	Fiber								19
1070951	17421 42ND STREET	OTTUMWA	IA	52501	1	11-Provider not reflected on the map	Provider only: The Map does not correctly reflect service that I facilitate to this location	1000	1000	Fiber								20
1367930	19726 30TH STREET	BLAKESBURG	IA	52536	1	11-Provider not reflected on the map	Provider only: The Map does not correctly reflect service that I facilitate to this location	1000	1000	Fiber								21
209084	12613 293RD STREET	BLOOMFIELD	IA	52537	1	11-Provider not reflected on the map	Provider only: The Map does not correctly reflect service that I facilitate to this location	1000	1000	Fiber								22
873754	18540 30TH STREET	DRAKESVILLE	IA	52552	1	11-Provider not reflected on the map	Provider only: The Map does not correctly reflect service that I facilitate to this location	1000	1000	Fiber								23
941313	4138 LAKE ROAD	OTTUMWA	IA	52501	1	11-Provider not reflected on the map	Provider only: The Map does not correctly reflect service that I facilitate to this location	1000	1000	Fiber								24
1218962	10894 FIR AVENUE	DRAKESVILLE	IA	52552	1	11-Provider not reflected on the map	Provider only: The Map does not correctly reflect service that I facilitate to this location	1000	1000	Fiber								25
1229217	2962 189TH AVENUE	BLAKESBURG	IA	52536	1	11-Provider not reflected on the map	Provider only: The Map does not correctly reflect service that I facilitate to this location	1000	1000	Fiber								26
1250097	12033 FLAX BOULEVARD	DRAKESVILLE	IA	52552	1	11-Provider not reflected on the map	Provider only: The Map does not correctly reflect service that I facilitate to this location	1000	1000	Fiber								27
1267005	27711 CLAY AVENUE	Bloomfield	IA	52537	1	11-Provider not reflected on the map	Provider only: The Map does not correctly reflect service that I facilitate to this location	1000	1000	Fiber								28
1326172	17119 42ND STREET	OTTUMWA	IA	52501	1	11-Provider not reflected on the map	Provider only: The Map does not correctly reflect service that I facilitate to this location	1000	1000	Fiber								29
21495	19362 SOAP CREEK ROAD	OTTUMWA	IA	52501	1	11-Provider not reflected on the map	Provider only: The Map does not correctly reflect service that I facilitate to this location	1000	1000	Fiber								30
405882	2595 20TH AVENUE	BLAKESBURG	IA	52536	1	11-Provider not reflected on the map	Provider only: The Map does not correctly reflect service that I facilitate to this location	1000	1000	Fiber								31
457162	3063 194TH AVENUE	BLAKESBURG	IA	52536	1	11-Provider not reflected on the map	Provider only: The Map does not correctly reflect service that I facilitate to this location	1000	1000	Fiber								32
587175	3104 180TH AVENUE	OTTUMWA	IA	52501	1	11-Provider not reflected on the map	Provider only: The Map does not correctly reflect service that I facilitate to this location	1000	1000	Fiber								33
1544116	19328 SOAP CREEK	OTTUMWA	IA	52501	1	11-Provider not reflected on the map	Provider only: The Map does not correctly reflect service that I facilitate to this location	1000	1000	Fiber								34
1401897	13134 ROUTE J40	MILTON	IA	52570	1	5-Reported service type (e.g., wireless/FTTH) does not exist	Provider or Community: I am challenging a broadband provider				Underserved (25/3 < available service < 100/20)						35	
154221	12862 ROUTE J40	MILTON	IA	52570	1	5-Reported service type (e.g., wireless/FTTH) does not exist	Provider or Community: I am challenging a broadband provider				Underserved (25/3 < available service < 100/20)						35	
230152	13607 230TH STREET	MILTON	IA	52570	1	5-Reported service type (e.g., wireless/FTTH) does not exist	Provider or Community: I am challenging a broadband provider				Underserved (25/3 < available service < 100/20)						35	
374461	14513 235TH STREET	MILTON	IA	52570	1	5-Reported service type (e.g., wireless/FTTH) does not exist	Provider or Community: I am challenging a broadband provider				Underserved (25/3 < available service < 100/20)						35	
384551	13875 235TH STREET	MILTON	IA	52570	1	5-Reported service type (e.g., wireless/FTTH) does not exist	Provider or Community: I am challenging a broadband provider				Underserved (25/3 < available service < 100/20)						35	
14444	14482 ROUTE J40	MILTON	IA	52570	1	5-Reported service type (e.g., wireless/FTTH) does not exist	Provider or Community: I am challenging a broadband provider				Underserved (25/3 < available service < 100/20)						35	
1129601	13259 230TH STREET	MILTON	IA	52570	1	5-Reported service type (e.g., wireless/FTTH) does not exist	Provider or Community: I am challenging a broadband provider				Underserved (25/3 < available service < 100/20)						35	
1130391	14212 ROUTE J40	MILTON	IA	52570	1	5-Reported service type (e.g., wireless/FTTH) does not exist	Provider or Community: I am challenging a broadband provider				Underserved (25/3 < available service < 100/20)						35	
1163181	14678 ROUTE J40	MILTON	IA	52570	1	5-Reported service type (e.g., wireless/FTTH) does not exist	Provider or Community: I am challenging a broadband provider				Underserved (25/3 < available service < 100/20)						35	
1382217	14832 ROUTE J40	MILTON	IA	52570	1	5-Reported service type (e.g., wireless/FTTH) does not exist	Provider or Community: I am challenging a broadband provider				Underserved (25/3 < available service < 100/20)						35	
14312	14322 ROUTE J40	MILTON	IA	52570	1	5-Reported service type (e.g., wireless/FTTH) does not exist	Provider or Community: I am challenging a broadband provider				Underserved (25/3 < available service < 100/20)						35	
105984	12487 ROUTE J40	MILTON	IA	52570	1	5-Reported service type (e.g., wireless/FTTH) does not exist	Provider or Community: I am challenging a broadband provider				Underserved (25/3 < available service < 100/20)						36	
195489	21261 CLOVER ROAD	MILTON	IA	52570	1	5-Reported service type (e.g., wireless/FTTH) does not exist	Provider or Community: I am challenging a broadband provider				Underserved (25/3 < available service < 100/20)						36	
461600	12063 ROUTE J40	MILTON	IA	52570	1	5-Reported service type (e.g., wireless/FTTH) does not exist	Provider or Community: I am challenging a broadband provider				Underserved (25/3 < available service < 100/20)						36	
617991	20329 CLOVER ROAD	MILTON	IA	52570	1	5-Reported service type (e.g., wireless/FTTH) does not exist	Provider or Community: I am challenging a broadband provider				Underserved (25/3 < available service < 100/20)						36	
76520	10752 205TH ROAD	MILTON	IA	52570	1	5-Reported service type (e.g., wireless/FTTH) does not exist	Provider or Community: I am challenging a broadband provider				Underserved (25/3 < available service < 100/20)						36	
764922	21363 CLOVER ROAD	MILTON	IA	52570	1	5-Reported service type (e.g., wireless/FTTH) does not exist	Provider or Community: I am challenging a broadband provider				Underserved (25/3 < available service < 100/20)						36	
1011624	11743 ROUTE J40	MILTON	IA	52570	1	5-Reported service type (e.g., wireless/FTTH) does not exist	Provider or Community: I am challenging a broadband provider				Underserved (25/3 < available service < 100/20)						36	
1236800	21193 CLOVER ROAD	MILTON	IA	52570	1	5-Reported service type (e.g., wireless/FTTH) does not exist	Provider or Community: I am challenging a broadband provider				Underserved (25/3 < available service < 100/20)						36	
1390394	21813 CLOVER ROAD	MILTON	IA	52570	1	5-Reported service type (e.g., wireless/FTTH) does not exist	Provider or Community: I am challenging a broadband provider				Underserved (25/3 < available service < 100/20)						36	
14309	20423 CLOVER ROAD	MILTON	IA	52570	1	5-Reported service type (e.g., wireless/FTTH) does not exist	Provider or Community: I am challenging a broadband provider				Underserved (25/3 < available service < 100/20)						36	
16562	10523 50TH AVENUE	OTTUMWA	IA	52501	1	5-Reported service type (e.g., wireless/FTTH) does not exist	Provider or Community: I am challenging a broadband provider				Underserved (25/3 < available service < 100/20)						37	
93733	24227 87TH STREET	BLAKESBURG	IA	52536	1	5-Reported service type (e.g., wireless/FTTH) does not exist	Provider or Community: I am challenging a broadband provider				Underserved (25/3 < available service < 100/20)						37	
216681	2776 DOUGLAS ROAD	IA	52567	1	5-Reported service type (e.g., wireless/FTTH) does not exist	Provider or Community: I am challenging a broadband provider					Underserved (25/3 < available service < 100/20)						37	
284122	11557 MONROE-WAY	BLAKESBURG	IA	52536	1	5-Reported service type (e.g., wireless/FTTH) does not exist	Provider or Community: I am challenging a broadband provider				Underserved (25/3 < available service < 100/20)						37	
291452	24444 WHISKEY RIDGE	BLAKESBURG	IA	52536	1	5-Reported service type (e.g., wireless/FTTH) does not exist	Provider or Community: I am challenging a broadband provider				Underserved (25/3 < available service < 100/20)						37	
203331	11352 235TH AVENUE	BLAKESBURG	IA	52536	1	5-Reported service type (e.g., wireless/FTTH) does not exist	Provider or Community: I am challenging a broadband provider				Underserved (25/3 < available service < 100/20)						37	
231552	23763 87TH STREET	BLAKESBURG	IA	52536	1	5-Reported service type (e.g., wireless/FTTH) does not exist	Provider or Community: I am challenging a broadband provider				Underserved (25/3 < available service < 100/20)						37	
231686	24563 87TH STREET	BLAKESBURG	IA	52536	1	5-Reported service type (e.g., wireless/FTTH) does not exist	Provider or Community: I am challenging a broadband provider				Underserved (25/3 < available service < 100/20)						37	
252626	10535 240TH AVENUE	BLAKESBURG	IA	52536	1	5-Reported service type (e.g., wireless/FTTH) does not exist	Provider or Community: I am challenging a broadband provider				Underserved (25/3 < available service < 100/20)						37	
259300	24332 WHISKEY RIDGE	BLAKESBURG	IA	52536	1	5-Reported service type (e.g., wireless/FTTH) does not exist	Provider or Community: I am challenging a broadband provider				Underserved (25/3 < available service < 100/20)						37	
291740	2602 BLADENSBURG	BATAVIA	IA	52513	1	5-Reported service type (e.g., wireless/FTTH) does not exist	Provider or Community: I am challenging a broadband provider				Underserved (25/3 < available service < 100/20)						37	
314450	471 13TH STREET	ELDON	IA	52554	1	5-Reported service type (e.g., wireless/FTTH) does not exist	Provider or Community: I am challenging a broadband provider				Underserved (25/3 < available service < 100/20)						37	
450317	4966 BLADENSBURG	OTTUMWA	IA	52501	1	5-Reported service type (e.g., wireless/FTTH) does not exist	Provider or Community: I am challenging a broadband provider				Underserved (25/3 < available service < 100/20)						37	
471850	7351 189TH STREET	IA	52531	1	5-Reported service type (e.g., wireless/FTTH) does not exist	Provider or Community: I am challenging a broadband provider					Underserved (25/3 < available service < 100/20)						37	
430898	7377 189TH STREET	ALBIA	IA	52531	1	5-Reported service type (e.g., wireless/FTTH) does not exist	Provider or Community: I am challenging a broadband provider				Underserved (25/3 < available service < 100/20)						37	
430918	7313 189TH STREET	ALBIA	IA	52531	1	5-Reported service type (e.g., wireless/FTTH) does not exist	Provider or Community: I am challenging a broadband provider				Underserved (25/3 < available service < 100/20)						37	
518639	24935 87TH STREET	BLAKESBURG	IA	52536	1	5-Reported service type (e.g., wireless/FTTH) does not exist	Provider or Community: I am challenging a broadband provider				Underserved (25/3 < available service < 100/20)						37	
551495	3481 42ND AVENUE	ELDON	IA	52554	1	5-Reported service type (e.g., wireless/FTTH) does not exist	Provider or Community: I am challenging a broadband provider				Underserved (25/3 < available service < 100/20)						37	
555969	4053 28TH STREET	ELDON	IA	52554	1	5-Reported service type (e.g., wireless/FTTH) does not exist	Provider or Community: I am challenging a broadband provider				Underserved (25/3 < available service < 100/20)						37	
624962	7336 164TH STREET	ALBIA	IA	52531	1	5-Reported service type (e.g., wireless/FTTH) does not exist	Provider or Community: I am challenging a broadband provider				Underserved (25/3 < available service < 100/20)						37	
625564	1615 42ND AVENUE	ELDON	IA	52554	1	5-Reported service type (e.g., wireless/FTTH) does not exist	Provider or Community: I am challenging a broadband provider				Underserved (25/3 < available service < 100/20)						37	
665496	24031 87TH STREET	BLAKESBURG	IA	52536	1	5												

Service Conditions The Map Should Reflect											Evidence: Upload all supporting information for this location in a single PDF. Enter the page number(s) in the cell below identifying the exact location of the proof in the PDF.				
IA Location ID	Street Address	City	State	Zip Code	No. of Units at (house, multi-residential units)	Basis for Challenge	Challenge Detail	Fastest download speed in Mbps for this type of service (Enter 0-2000)	Fastest upload speed in Mbps for this type of service (Enter 0-2000)	Technology Type	Is this location served, underserved, or unserved?	Survey Statement/Response			
												Technology Type	Speed test at this location	Other	
1036746	10940 MONROE-WA	ALBIA	IA	52531	1	S-reported service type (e.g., wireless/FTTH) does not exist	Provider or Community: I am challenging a broadband provider				Underserved (25/3 < available service - 100/20)	Wired			37
1060245	3603 BLADENBURG	OTTUMWA	IA	52501	1	S-reported service type (e.g., wireless/FTTH) does not exist	Provider or Community: I am challenging a broadband provider				Underserved (25/3 < available service - 100/20)	Wired			37
1062487	4482 OWAN HIGHWAY	ELDON	IA	52554	1	S-reported service type (e.g., wireless/FTTH) does not exist	Provider or Community: I am challenging a broadband provider				Underserved (25/3 < available service - 100/20)	Wired			37
1083410	23981 87TH STREET	BLAKESBURG	IA	52536	1	S-reported service type (e.g., wireless/FTTH) does not exist	Provider or Community: I am challenging a broadband provider				Underserved (25/3 < available service - 100/20)	Wired			37
1087516	4485 BLADENBURG	OTTUMWA	IA	52501	1	S-reported service type (e.g., wireless/FTTH) does not exist	Provider or Community: I am challenging a broadband provider				Underserved (25/3 < available service - 100/20)	Wired			37
1111389	7102 255TH STREET	BLAKESBURG	IA	52536	1	S-reported service type (e.g., wireless/FTTH) does not exist	Provider or Community: I am challenging a broadband provider				Underserved (25/3 < available service - 100/20)	Wired			37
1139595	11360 MONROE-WA	ALBIA	IA	52531	1	S-reported service type (e.g., wireless/FTTH) does not exist	Provider or Community: I am challenging a broadband provider				Underserved (25/3 < available service - 100/20)	Wired			37
1154997	24502 WHEATSTOCK ROAD	BLAKESBURG	IA	52536	1	S-reported service type (e.g., wireless/FTTH) does not exist	Provider or Community: I am challenging a broadband provider				Underserved (25/3 < available service - 100/20)	Wired			37
1193983	4290 IOWA HIGHWAY	ELDON	IA	52554	1	S-reported service type (e.g., wireless/FTTH) does not exist	Provider or Community: I am challenging a broadband provider				Underserved (25/3 < available service - 100/20)	Wired			37
1225049	3223 42ND AVENUE	ELDON	IA	52554	1	S-reported service type (e.g., wireless/FTTH) does not exist	Provider or Community: I am challenging a broadband provider				Underserved (25/3 < available service - 100/20)	Wired			37
1261331	2130 IOWA HIGHWAY	ELDON	IA	52554	1	S-reported service type (e.g., wireless/FTTH) does not exist	Provider or Community: I am challenging a broadband provider				Underserved (25/3 < available service - 100/20)	Wired			37
1312390	3880 IOWA HIGHWAY	ELDON	IA	52554	1	S-reported service type (e.g., wireless/FTTH) does not exist	Provider or Community: I am challenging a broadband provider				Underserved (25/3 < available service - 100/20)	Wired			37
1326047	2778 DOUGLAS ROAD	ELDON	IA	52567	1	S-reported service type (e.g., wireless/FTTH) does not exist	Provider or Community: I am challenging a broadband provider				Underserved (25/3 < available service - 100/20)	Wired			37
1342925	4216 IOWA HIGHWAY	ELDON	IA	52554	1	S-reported service type (e.g., wireless/FTTH) does not exist	Provider or Community: I am challenging a broadband provider				Underserved (25/3 < available service - 100/20)	Wired			37
1347193	3506 BLADENBURG	BATAVIA	IA	52583	1	S-reported service type (e.g., wireless/FTTH) does not exist	Provider or Community: I am challenging a broadband provider				Underserved (25/3 < available service - 100/20)	Wired			37
1381718	24897 87TH STREET	BLAKESBURG	IA	52536	1	S-reported service type (e.g., wireless/FTTH) does not exist	Provider or Community: I am challenging a broadband provider				Underserved (25/3 < available service - 100/20)	Wired			37
1387861	24005 115TH STREET	BLAKESBURG	IA	52536	1	S-reported service type (e.g., wireless/FTTH) does not exist	Provider or Community: I am challenging a broadband provider				Underserved (25/3 < available service - 100/20)	Wired			37
1388601	8779 38TH STREET	ELDON	IA	52554	1	S-reported service type (e.g., wireless/FTTH) does not exist	Provider or Community: I am challenging a broadband provider				Underserved (25/3 < available service - 100/20)	Wired			37
1431752	23541 87TH STREET	BLAKESBURG	IA	52536	1	S-reported service type (e.g., wireless/FTTH) does not exist	Provider or Community: I am challenging a broadband provider				Underserved (25/3 < available service - 100/20)	Wired			37
1432100	3946 IOWA HIGHWAY	ELDON	IA	52554	1	S-reported service type (e.g., wireless/FTTH) does not exist	Provider or Community: I am challenging a broadband provider				Underserved (25/3 < available service - 100/20)	Wired			37
1447328	7368 168TH STREET	ALBIA	IA	52531	1	S-reported service type (e.g., wireless/FTTH) does not exist	Provider or Community: I am challenging a broadband provider				Underserved (25/3 < available service - 100/20)	Wired			37
1459537	23959 115TH STREET	BLAKESBURG	IA	52536	1	S-reported service type (e.g., wireless/FTTH) does not exist	Provider or Community: I am challenging a broadband provider				Underserved (25/3 < available service - 100/20)	Wired			37
71814	13747 BETHEL ROCK	DOUGS	IA	52553	1	S-reported service type (e.g., wireless/FTTH) does not exist	Provider or Community: I am challenging a broadband provider				Underserved (25/3 < available service - 100/20)	Wired			37
94015	11153 145TH STREET	DOUGS	IA	52553	1	S-reported service type (e.g., wireless/FTTH) does not exist	Provider or Community: I am challenging a broadband provider				Underserved (25/3 < available service - 100/20)	Wired			37
98646	12453 EAGLE DRIVE	SELMA	IA	52588	1	S-reported service type (e.g., wireless/FTTH) does not exist	Provider or Community: I am challenging a broadband provider				Underserved (25/3 < available service - 100/20)	Wired			37
244922	12417 EAGLE DRIVE	SELMA	IA	52588	1	S-reported service type (e.g., wireless/FTTH) does not exist	Provider or Community: I am challenging a broadband provider				Underserved (25/3 < available service - 100/20)	Wired			37
247442	12947 EAGLE DRIVE	DOUGS	IA	52551	1	S-reported service type (e.g., wireless/FTTH) does not exist	Provider or Community: I am challenging a broadband provider				Underserved (25/3 < available service - 100/20)	Wired			37
27823	13812 ACORN AVENUE	SELMA	IA	52588	1	S-reported service type (e.g., wireless/FTTH) does not exist	Provider or Community: I am challenging a broadband provider				Underserved (25/3 < available service - 100/20)	Wired			37
877200	2987 BETHEL ROCK	DOUGS	IA	52553	1	S-reported service type (e.g., wireless/FTTH) does not exist	Provider or Community: I am challenging a broadband provider				Underserved (25/3 < available service - 100/20)	Wired			37
1095066	2572 ASH AVENUE	BATAVIA	IA	52583	1	S-reported service type (e.g., wireless/FTTH) does not exist	Provider or Community: I am challenging a broadband provider				Underserved (25/3 < available service - 100/20)	Wired			37
1039134	12607 EAGLE DRIVE	SELMA	IA	52588	1	S-reported service type (e.g., wireless/FTTH) does not exist	Provider or Community: I am challenging a broadband provider				Underserved (25/3 < available service - 100/20)	Wired			37
1110880	14130 ACORN AVENUE	SELMA	IA	52588	1	S-reported service type (e.g., wireless/FTTH) does not exist	Provider or Community: I am challenging a broadband provider				Underserved (25/3 < available service - 100/20)	Wired			37
1120051	12715 EAGLE DRIVE	DOUGS	IA	52553	1	S-reported service type (e.g., wireless/FTTH) does not exist	Provider or Community: I am challenging a broadband provider				Underserved (25/3 < available service - 100/20)	Wired			37
1238661	13461 BETHEL ROCK	DOUGS	IA	52553	1	S-reported service type (e.g., wireless/FTTH) does not exist	Provider or Community: I am challenging a broadband provider				Underserved (25/3 < available service - 100/20)	Wired			37
1276716	2589 JEFFERSON WAY	ELDON	IA	52553	1	S-reported service type (e.g., wireless/FTTH) does not exist	Provider or Community: I am challenging a broadband provider				Underserved (25/3 < available service - 100/20)	Wired			37
1399009	1027 260TH STREET	ELDON	IA	52533	1	S-reported service type (e.g., wireless/FTTH) does not exist	Provider or Community: I am challenging a broadband provider				Underserved (25/3 < available service - 100/20)	Wired			37
1471972	12732 ACORN AVENUE	SELMA	IA	52588	1	S-reported service type (e.g., wireless/FTTH) does not exist	Provider or Community: I am challenging a broadband provider				Underserved (25/3 < available service - 100/20)	Wired			37
30321	1567 207TH STREET	LIBERTYVILLE	IA	52567	1	S-reported service type (e.g., wireless/FTTH) does not exist	Provider or Community: I am challenging a broadband provider				Underserved (25/3 < available service - 100/20)	Wired			38
612647	2640 DOUGS ROAD	LIBERTYVILLE	IA	52567	1	S-reported service type (e.g., wireless/FTTH) does not exist	Provider or Community: I am challenging a broadband provider				Underserved (25/3 < available service - 100/20)	Wired			38
10514	13850 160TH STREET	ALBIA	IA	52531	1	S-reported service type (e.g., wireless/FTTH) does not exist	Provider or Community: I am challenging a broadband provider				Underserved (25/3 < available service - 100/20)	Wired			38
37831	2539 655TH AVENUE	ALBIA	IA	52531	1	S-reported service type (e.g., wireless/FTTH) does not exist	Provider or Community: I am challenging a broadband provider				Underserved (25/3 < available service - 100/20)	Wired			38
55816	2570 645TH AVENUE	ALBIA	IA	52531	1	S-reported service type (e.g., wireless/FTTH) does not exist	Provider or Community: I am challenging a broadband provider				Underserved (25/3 < available service - 100/20)	Wired			38
74876	16525 ROUTE V64	DOUGS	IA	52551	1	S-reported service type (e.g., wireless/FTTH) does not exist	Provider or Community: I am challenging a broadband provider				Underserved (25/3 < available service - 100/20)	Wired			38
91254	2538 645TH AVENUE	ALBIA	IA	52531	1	S-reported service type (e.g., wireless/FTTH) does not exist	Provider or Community: I am challenging a broadband provider				Underserved (25/3 < available service - 100/20)	Wired			38
85222	4220 WASHINGTON	ELDON	IA	52554	1	S-reported service type (e.g., wireless/FTTH) does not exist	Provider or Community: I am challenging a broadband provider				Underserved (25/3 < available service - 100/20)	Wired			38
139349	2442 645TH AVENUE	ALBIA	IA	52531	1	S-reported service type (e.g., wireless/FTTH) does not exist	Provider or Community: I am challenging a broadband provider				Underserved (25/3 < available service - 100/20)	Wired			38
104761	13983 172ND STREET	DOUGS	IA	52551	1	S-reported service type (e.g., wireless/FTTH) does not exist	Provider or Community: I am challenging a broadband provider				Underserved (25/3 < available service - 100/20)	Wired			38
124586	16083 ROUTE V64	DOUGS	IA	52551	1	S-reported service type (e.g., wireless/FTTH) does not exist	Provider or Community: I am challenging a broadband provider				Underserved (25/3 < available service - 100/20)	Wired			38
126543	16543 ROUTE V64	DOUGS	IA	52551	1	S-reported service type (e.g., wireless/FTTH) does not exist	Provider or Community: I am challenging a broadband provider				Underserved (25/3 < available service - 100/20)	Wired			38
134184	5011 260TH STREET	ALBIA	IA	52531	1	S-reported service type (e.g., wireless/FTTH) does not exist	Provider or Community: I am challenging a broadband provider				Underserved (25/3 < available service - 100/20)	Wired			38
151378	3414 WASHINGTON	ELDON	IA	52554	1	S-reported service type (e.g., wireless/FTTH) does not exist	Provider or Community: I am challenging a broadband provider				Underserved (25/3 < available service - 100/20)	Wired			38
161468	14038 160TH STREET	DOUGS	IA	52551	1	S-reported service type (e.g., wireless/FTTH) does not exist	Provider or Community: I am challenging a broadband provider				Underserved (25/3 < available service - 100/20)	Wired			38
181911	16655 ROUTE V64	DOUGS	IA	52551	1	S-reported service type (e.g., wireless/FTTH) does not exist	Provider or Community: I am challenging a broadband provider				Underserved (25/3 < available service - 100/20)	Wired			38
21017	2672 DOUGS ROAD	LIBERTYVILLE	IA	52567	1	S-reported service type (e.g., wireless/FTTH) does not exist	Provider or Community: I am challenging a broadband provider				Underserved (25/3 < available service - 100/20)	Wired			38
229543	2458 645TH AVENUE	ALBIA	IA	52531	1	S-reported service type (e.g., wireless/FTTH) does not exist	Provider or Community: I am challenging a broadband provider				Underserved (25/3 < available service - 100/20)	Wired			38
274334	2468 645TH AVENUE	ALBIA	IA	52531	1	S-reported service type (e.g., wireless/FTTH) does not exist	Provider or Community: I am challenging a broadband provider				Underserved (25/3 < available service - 100/20)	Wired			38
302143	2962 45TH STREET	ELDON	IA	52554	1	S-reported service type (e.g., wireless/FTTH) does not exist	Provider or Community: I am challenging a broadband provider				Underserved (25/3 < available service - 100/20)	Wired			38
306841	15008 105TH ROAD	LIBERTYVILLE	IA	52567	1	S-reported service type (e.g., wireless/FTTH) does not exist	Provider or Community: I am challenging a broadband provider				Underserved (25/3 < available service - 100/20)	Wired			38
414715	2469 655TH AVENUE	ALBIA	IA	52531	1	S-reported service type (e.g., wireless/FTTH) does not exist	Provider or Community: I am challenging a broadband provider				Underserved (25/3 < available service - 100/20)	Wired			38
410929	6415 233TH STREET	ALBIA	IA	52531	1	S-reported service type (e.g., wireless/FTTH) does not exist	Provider or Community: I am challenging a broadband provider				Underserved (25/3 < available service - 100/20)	Wired			38
455592	5187 IOWA HIGHWAY	ELDON	IA	52554	1	S-reported service type (e.g., wireless/FTTH) does not exist	Provider or Community: I am challenging a broadband provider				Underserved (25/3 < available service - 100/20)	Wired			38
456400	14727 110TH STREET	DOUGS	IA	52551	1	S-reported service type (e.g., wireless/FTTH) does not exist	Provider or Community: I am challenging a broadband provider				Underserved (25/3 < available service - 100/20)	Wired			38
461386	5324 25TH AVENUE	ELDON	IA	52554	1	S-reported service type (e.g., wireless/FTTH) does not exist	Provider or Community: I am challenging a broadband provider				Underserved (25/3 < available service - 100/20)	Wired			38
464959	19873 ROUTE V64	DOUGS	IA	52551	1	S-reported service type (e.g., wireless/FTTH) does not exist	Provider or Community: I am challenging a broadband provider				Underserved (25/3 < available service - 100/20)	Wired			38
485233	14723 110TH STREET	ALBIA	IA	52531	1	S-reported service type (e.g., wireless/FTTH) does not exist	Provider or Community: I am challenging a broadband provider				Underserved (25/3 < available service - 100/20)	Wired			38
513665	2643 FRI AVENUE	LIBERTYVILLE	IA	52567	1	S-reported service type (e.g., wireless/FTTH) does not exist	Provider or Community: I am challenging a broadband provider				Underserved (25/3 < available service - 100/20)	Wired			38
500235	6504 240TH STREET	ALBIA	IA	52531	1	S-reported service type (e.g., wireless/FTTH) does not exist	Provider or Community: I am challenging a broadband provider				Underserved (25/3 < available service - 100/20)	Wired			38
508423	14771 110TH STREET	DOUGS	IA	52551	1	S-reported service type (e.g., wireless/FTTH) does not exist	Provider or Community: I am challenging a broadband provider				Underserved (25/3 < available service - 100/20)	Wired			38
513444	2020 645TH AVENUE	ALBIA	IA	52531	1	S-reported service type (e.g., wireless/FTTH) does not exist	Provider or Community: I am challenging a broadband provider				Underserved (25/3 < available service - 100/20)	Wired			38
571894	2894 WASHINGTON	ELDON	IA	52554	1	S-reported service type (e.g., wireless/FTTH) does not exist	Provider or Community: I am challenging a broadband provider				Underserved (25/3 < available service - 100/20)	Wired			38
631480	2541 655TH AVENUE	ALBIA	IA	52531	1	S-reported service type (e.g., wireless/FTTH) does not exist	Provider or Community: I am challenging a broadband provider				Underserved (25/3 < available service - 100/20)	Wired			38
648270	3148 CHIEF WAPELLE	ELDON	IA	52554	1	S-reported service type (e.g., wireless/FTTH) does not exist	Provider or Community: I am challenging a broadband provider				Underserved (25/3 < available service - 100/20)	Wired			38
660312	4143 IOWA HIGHWAY	ELDON	IA	52554	1	S-reported service type (e.g., wireless/FTTH) does not exist	Provider or Community: I am challenging a broadband provider				Underserved (25/3 < available service - 100/20)	Wired			38
665400	2494 45TH STREET	ELDON	IA	52554	1	S-reported service type (e.g., wireless/FTTH) does not exist	Provider or Community: I am challenging a broadband provider				Underserved (25/3 < available service - 100/20)	Wired			38
681480	6536 240TH STREET	ALBIA	IA	52531	1	S-reported service type (e.g., wireless/FTTH) does not exist	Provider or Community: I am challenging a broadband provider				Underserved (25/3 < available service - 100/20)	Wired			38
687940	16308 DEWEERRY	DOUGS	IA	52551	1	S-reported service type (e.g., wireless/FTTH) does not exist	Provider or Community: I am challenging a broadband provider				Underserved (25/3 < available service - 100/20)	Wired			38
732757	6498 240TH STREET	ALBIA	IA	52531	1	S-reported service type (e.g., wireless/FTTH) does not exist	Provider or Community: I am challenging a broadband provider				Underserved (25/3 < available service - 100/20)	Wired			38
805300	13857 172ND STREET	DOUGS	IA	52551	1	S-reported service type (e.g., wireless/FTTH) does not exist	Provider or Community: I am challenging a broadband provider				Underserved (25/3 < available service - 100/20)	Wired			38
848817	689														









## Citizens Mutual Telephone Cooperative Challenge Location Supporting Documentation

- Citizens Mutual is challenging locations in two general groups:
  - Locations that are within our service area that is shown as 'likely eligible' but is either currently connected to our fiber network or is within a distance that a connection can be established within 10 business days (installation of a drop cable), upon request by the business/resident. Map clips are provided as the supporting documentation that fiber is either present at the location or nearby.
  - Locations that are outside our service area and we believe lacks adequate broadband service and Citizens Mutual is interested in applying for grant funds. These locations are reported as being served by DSL at speeds greater than 100 mbps. Citizens Mutual does not believe network connections exist that can facilitate these speeds based upon our proximity and field work in these areas. Therefore, we are hopeful the OCIO can request the reporting carrier provide the relevant information (copper loop length, gauge of cable, etc) that would verify the DSL speeds that are attainable at these locations to support either their reported speeds or Citizens Mutual's challenge.

This location is currently connected to Citizens Mutual's fiber network.

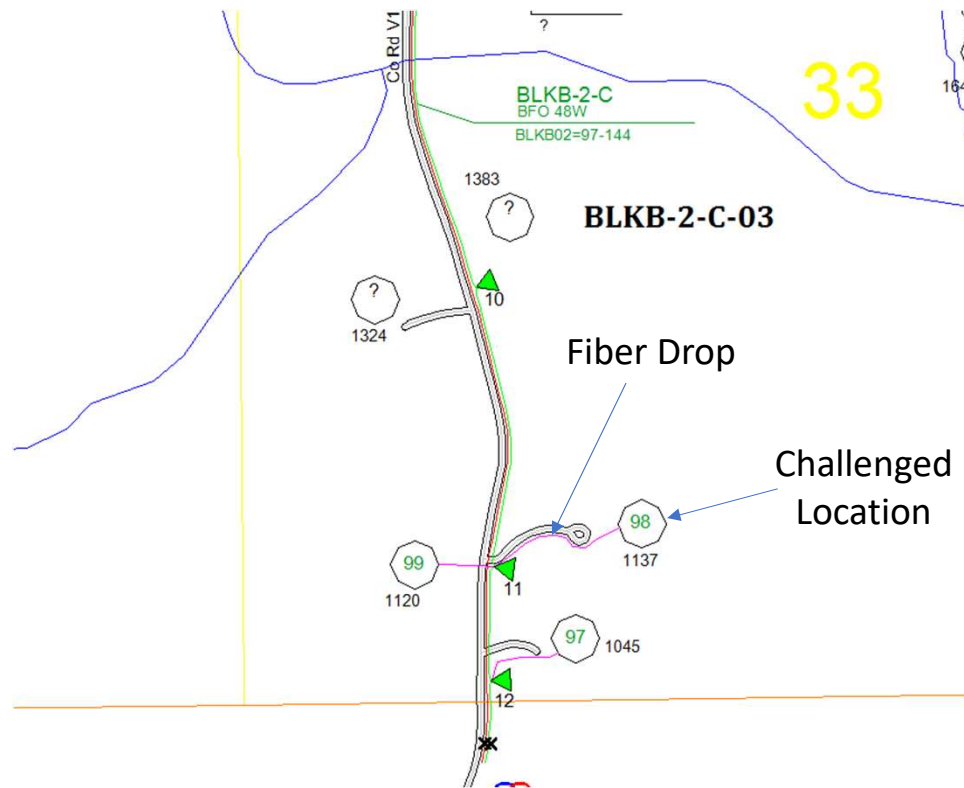

This location is currently connected to Citizens Mutual's fiber network.

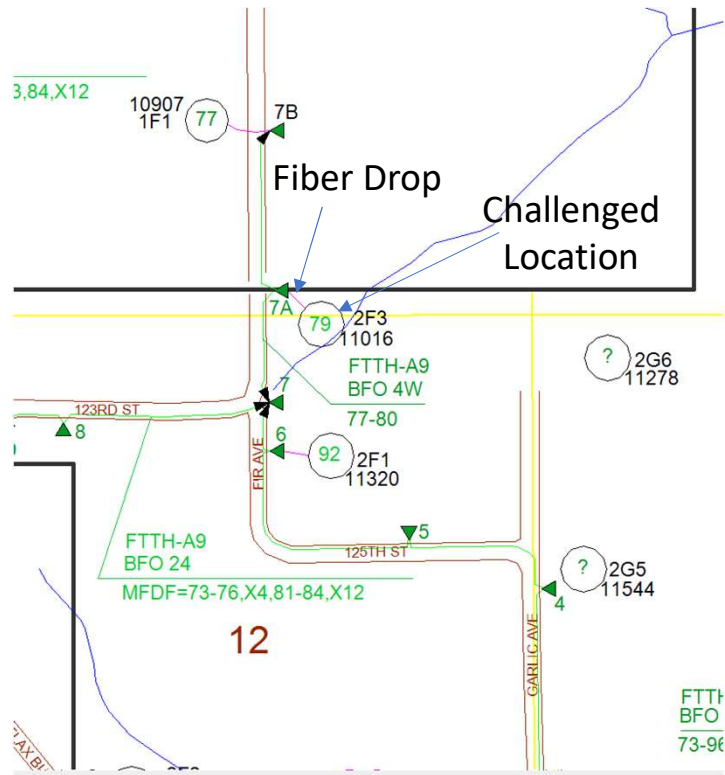

This location is currently connected to Citizens Mutual's fiber network.

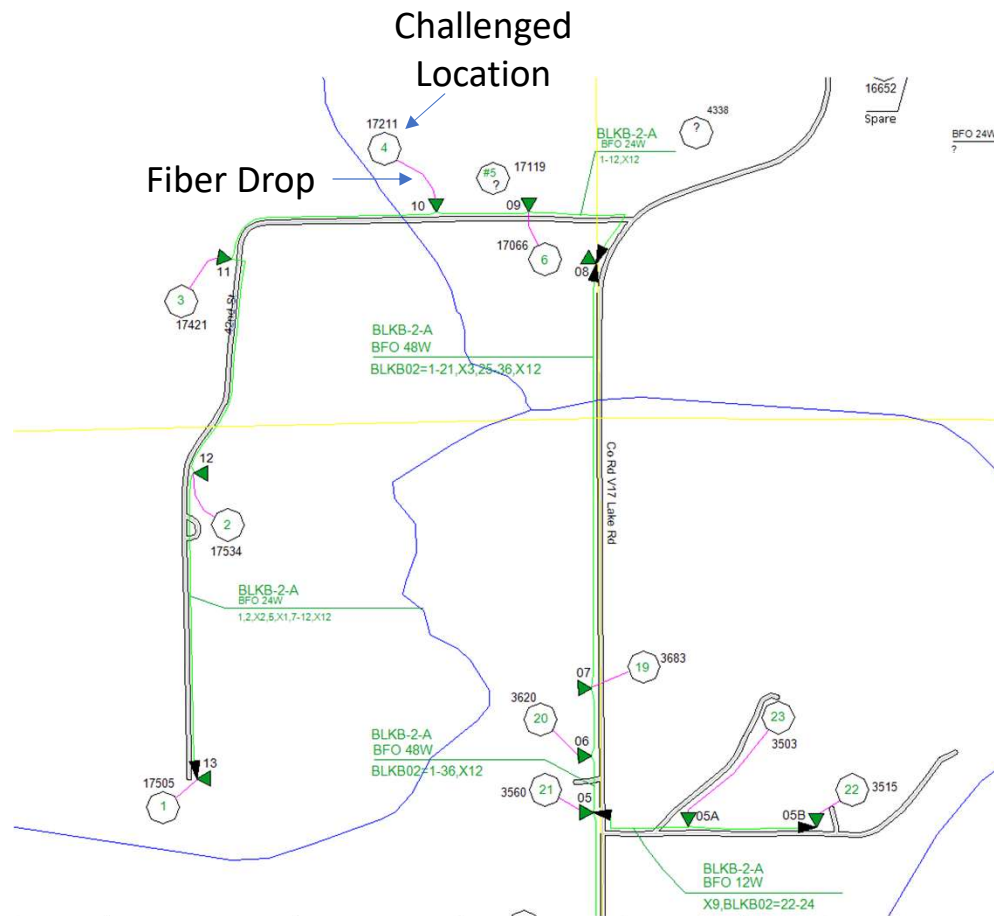

This location is currently connected to Citizens Mutual's fiber network.

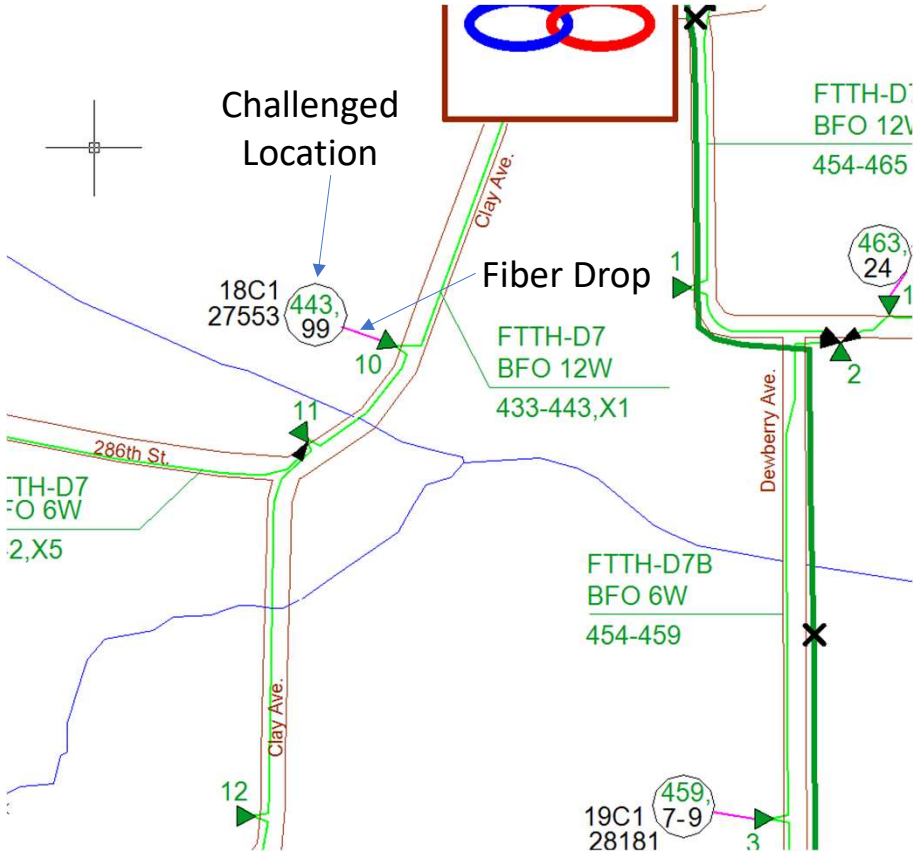

Challenged  
Location \

This location is currently connected to Citizens Mutual's fiber network.

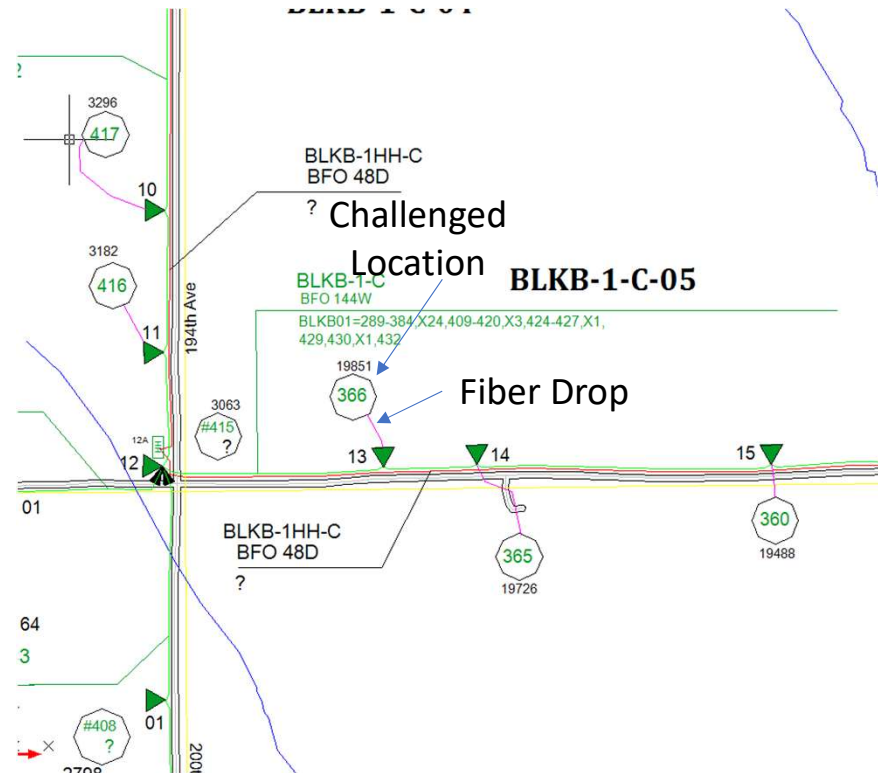



This location is currently connected to Citizens Mutual's fiber network.

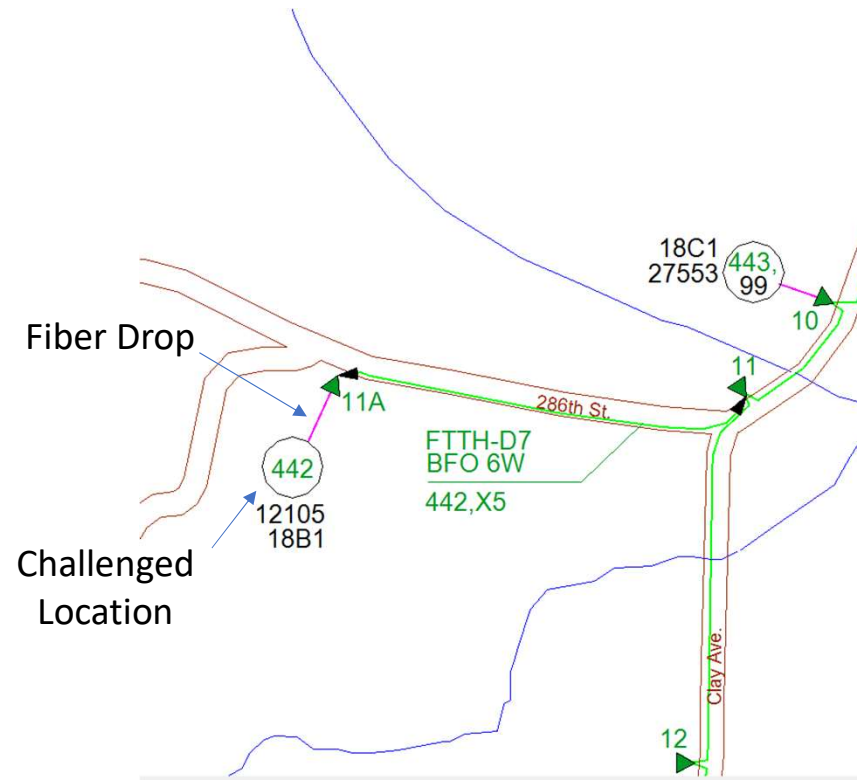

This location is currently connected to Citizens Mutual's fiber network.

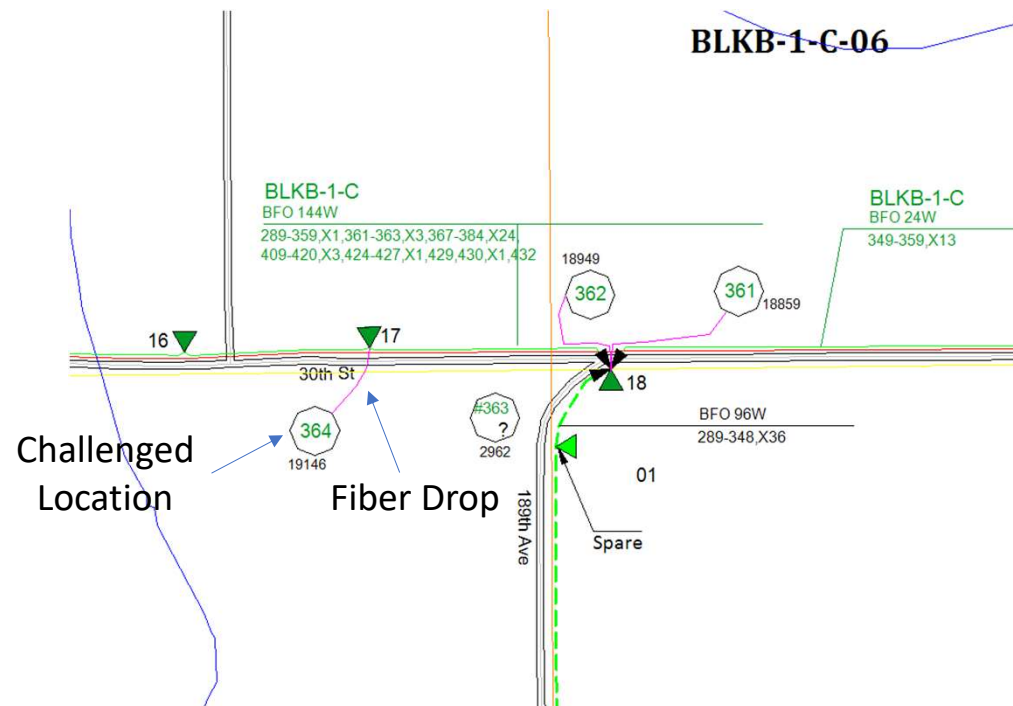

This location is currently connected to Citizens Mutual's fiber network.

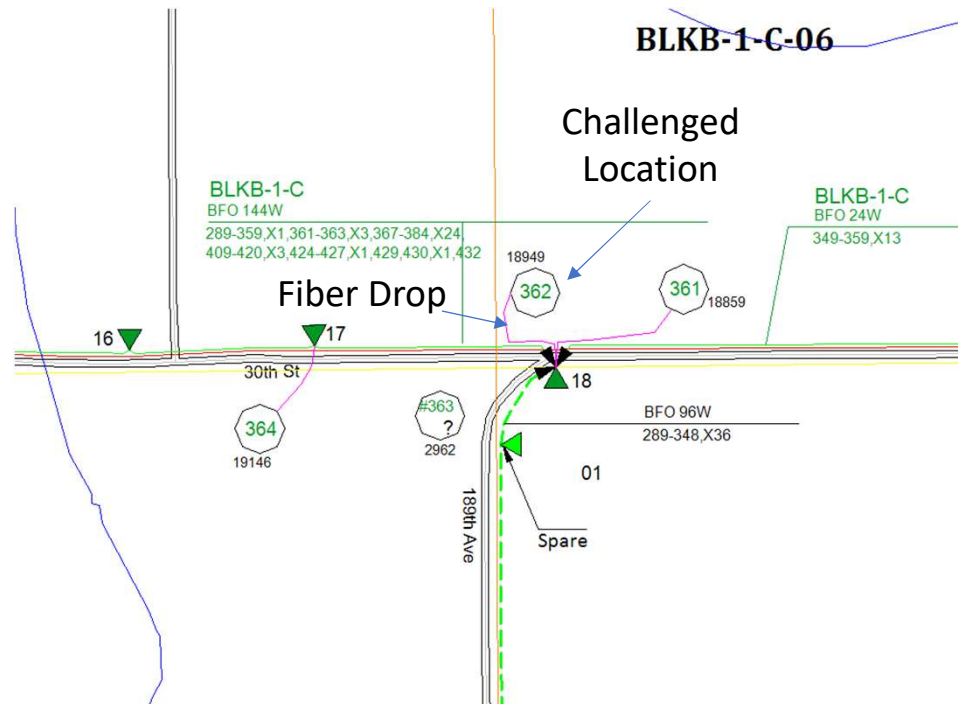

This location is currently connected to Citizens Mutual's fiber network.

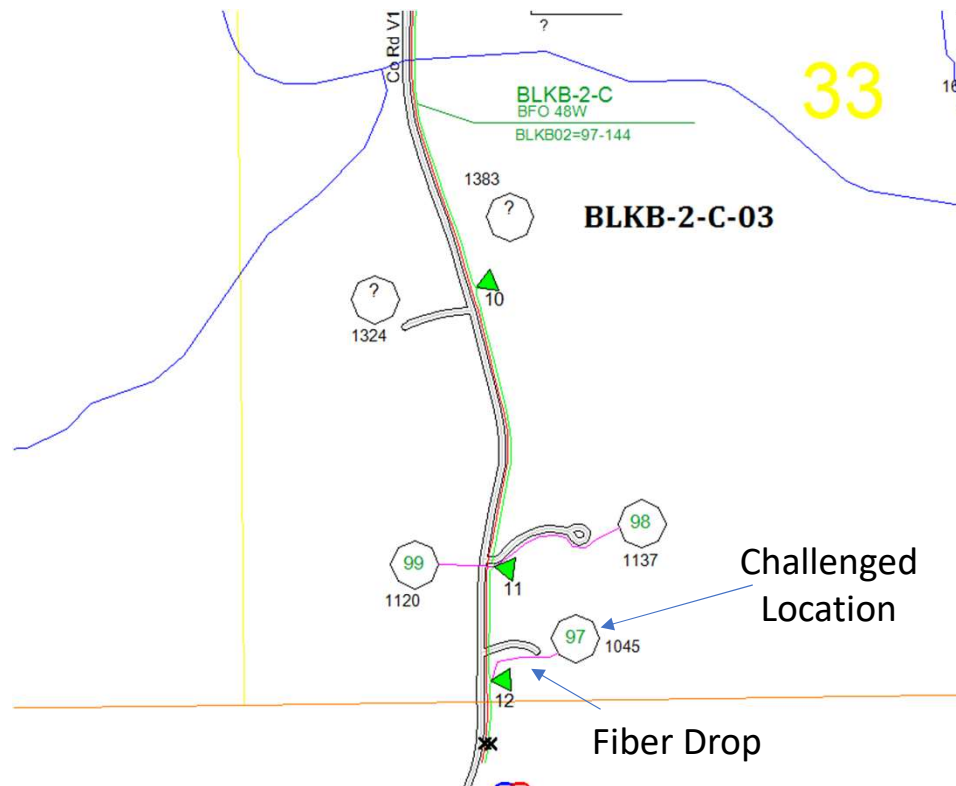

This location is currently connected to Citizens Mutual's fiber network.

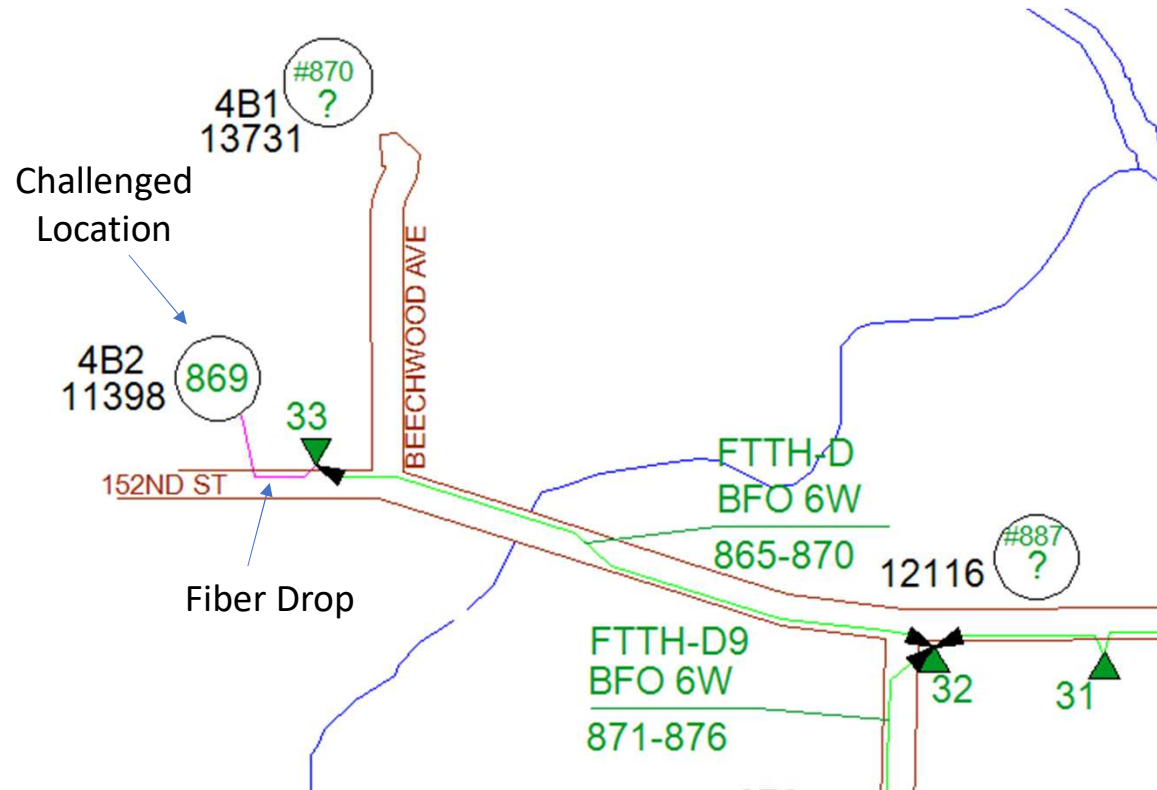

This location is currently connected to Citizens Mutual's fiber network.

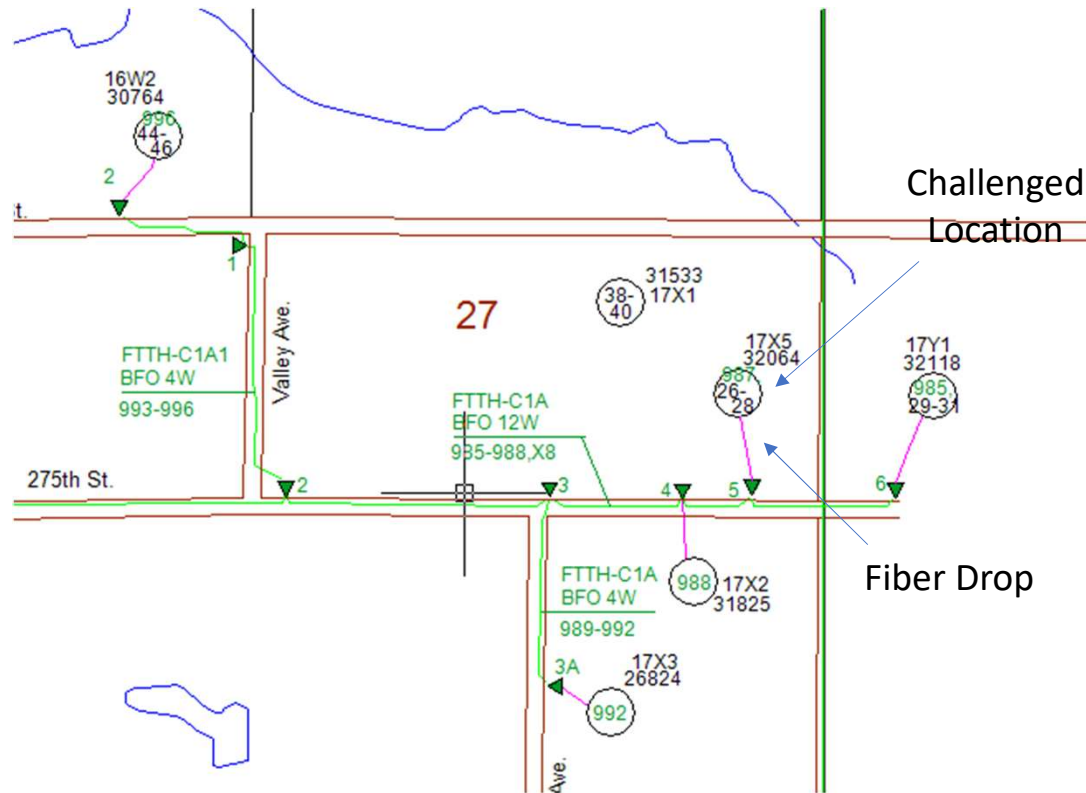

This location is currently connected to Citizens Mutual's fiber network.

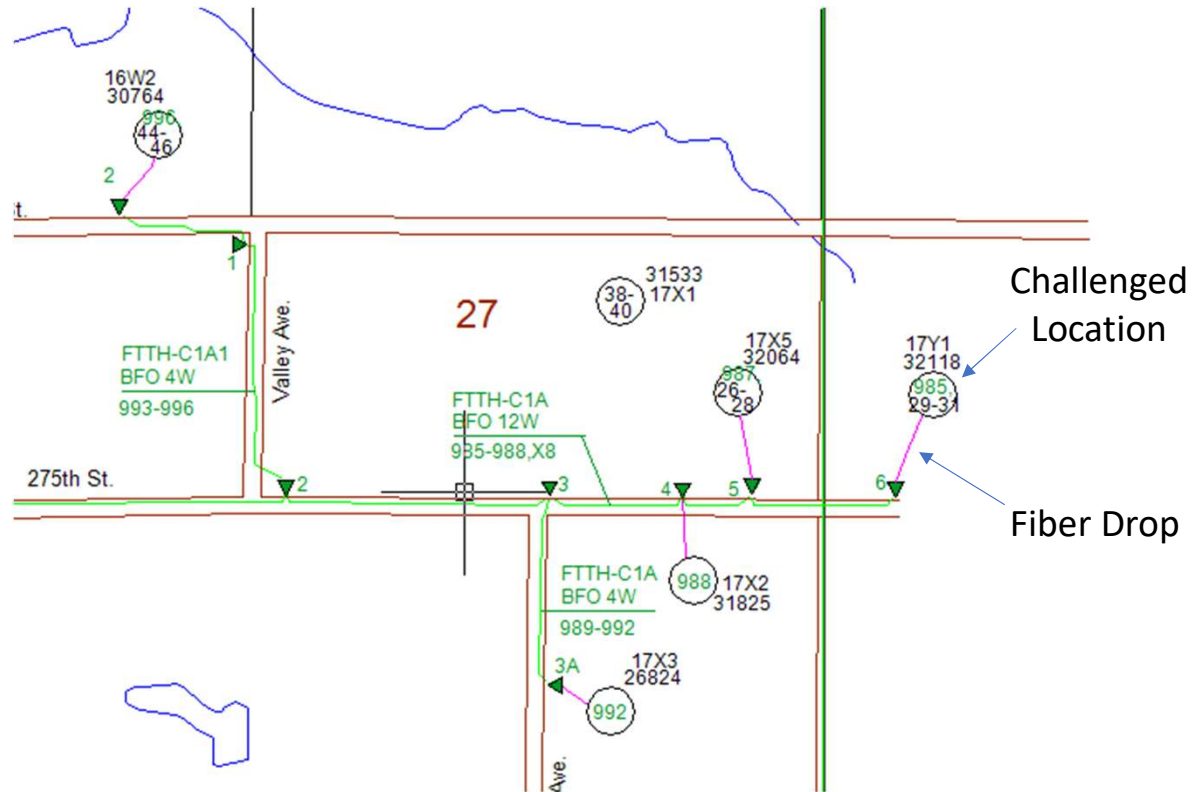

This location is currently connected to Citizens Mutual's fiber network.

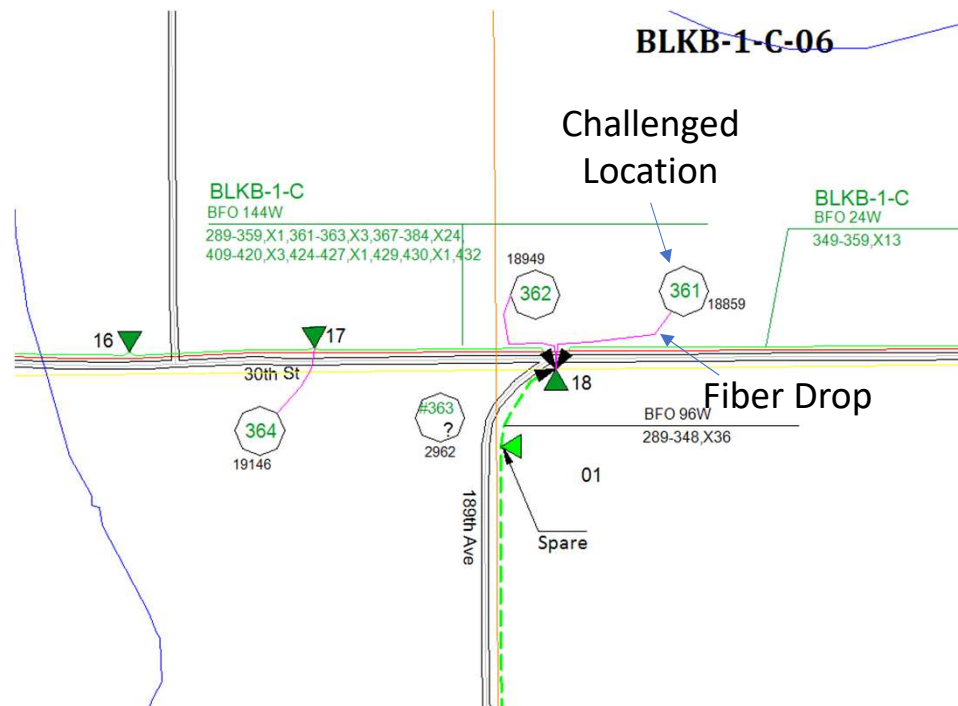



This location is currently connected to Citizens Mutual's fiber network.

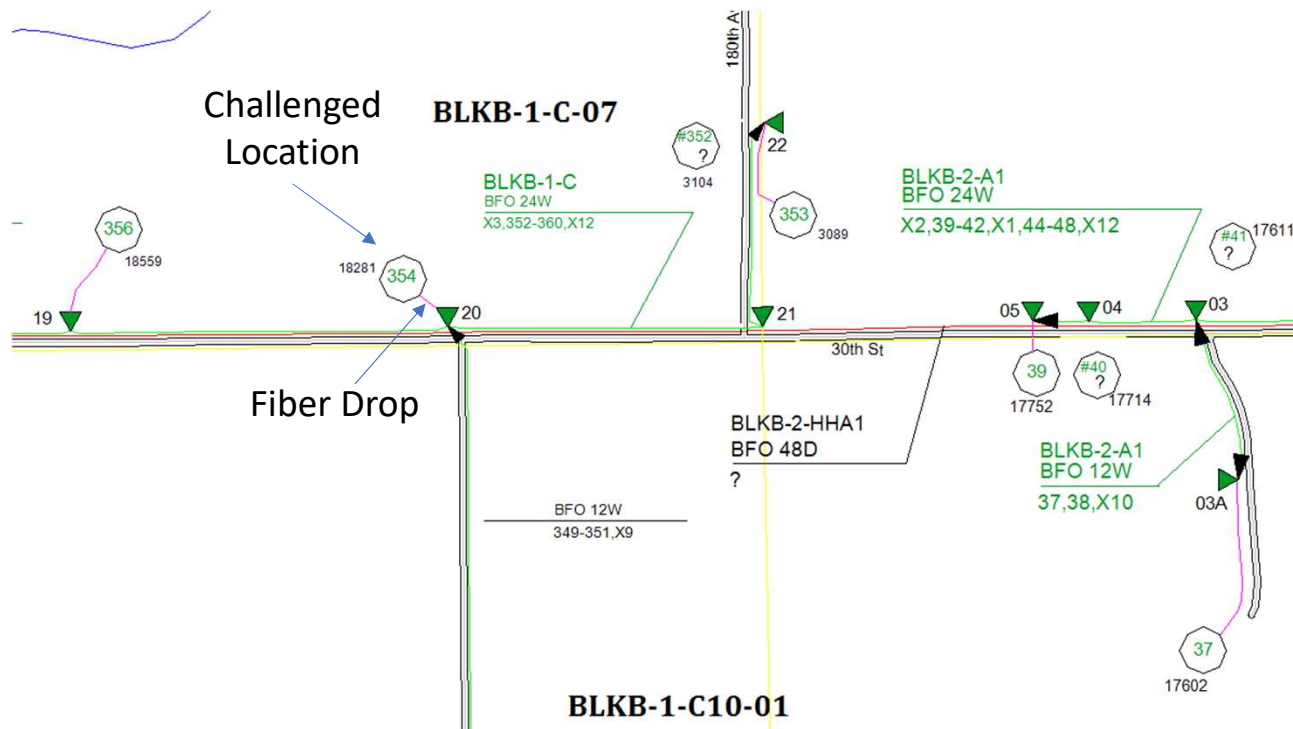

This location is currently connected to Citizens Mutual's fiber network.

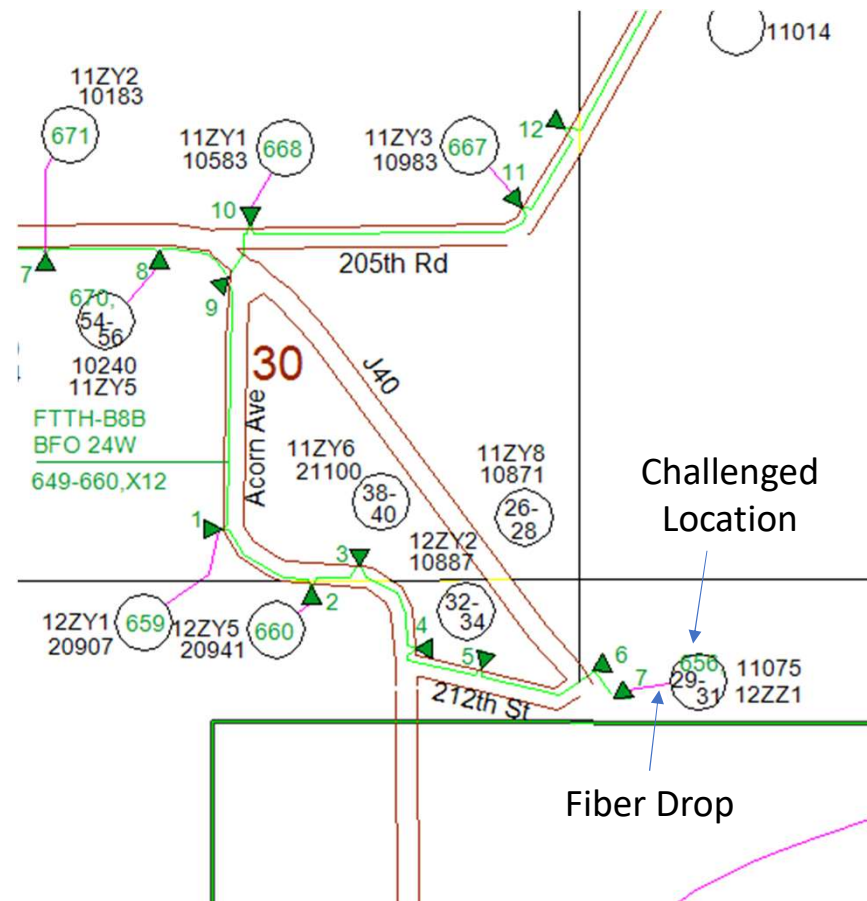

This location is currently connected to Citizens Mutual's fiber network.

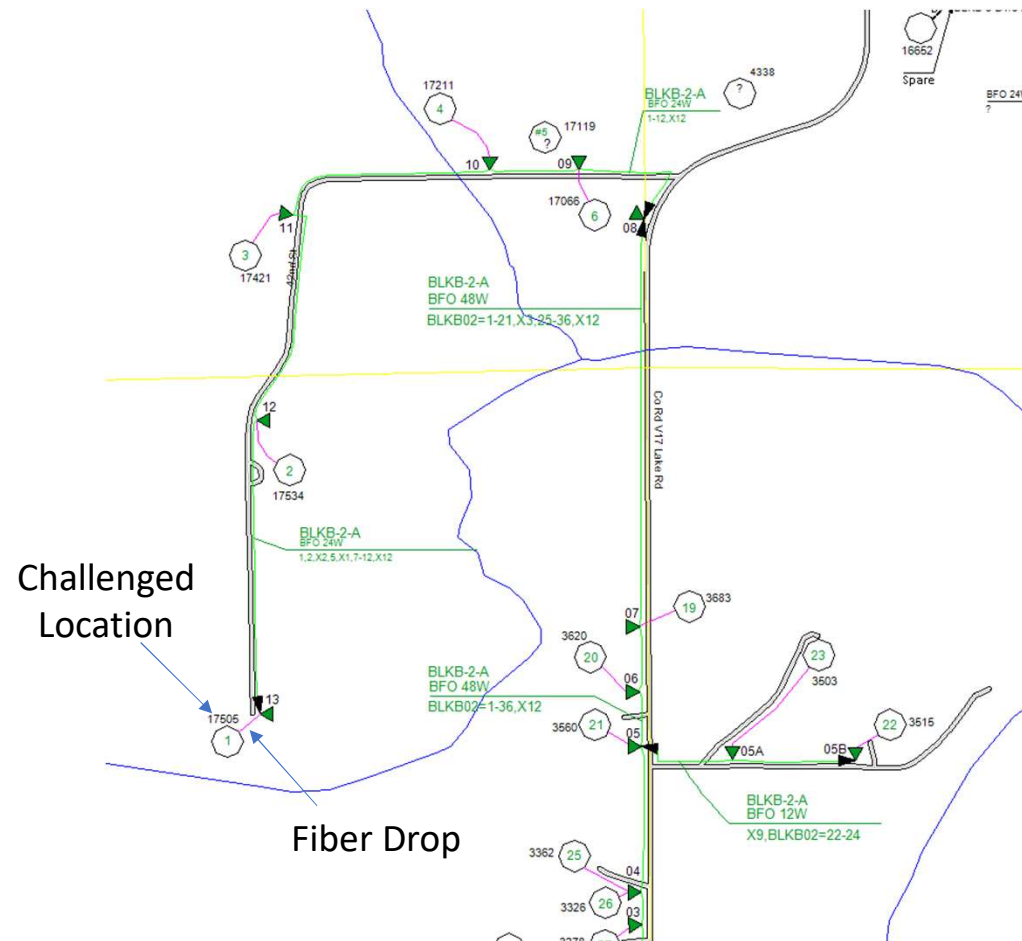

This location is currently connected to Citizens Mutual's fiber network.

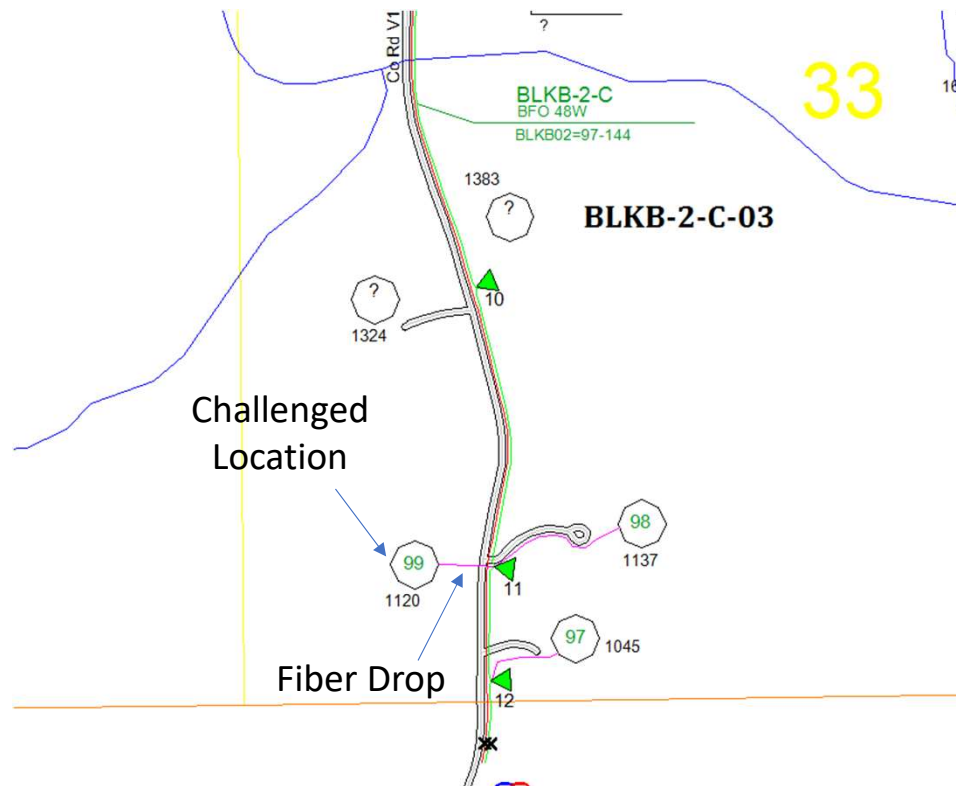

This location is currently connected to Citizens Mutual's fiber network.

Challenged  
Location

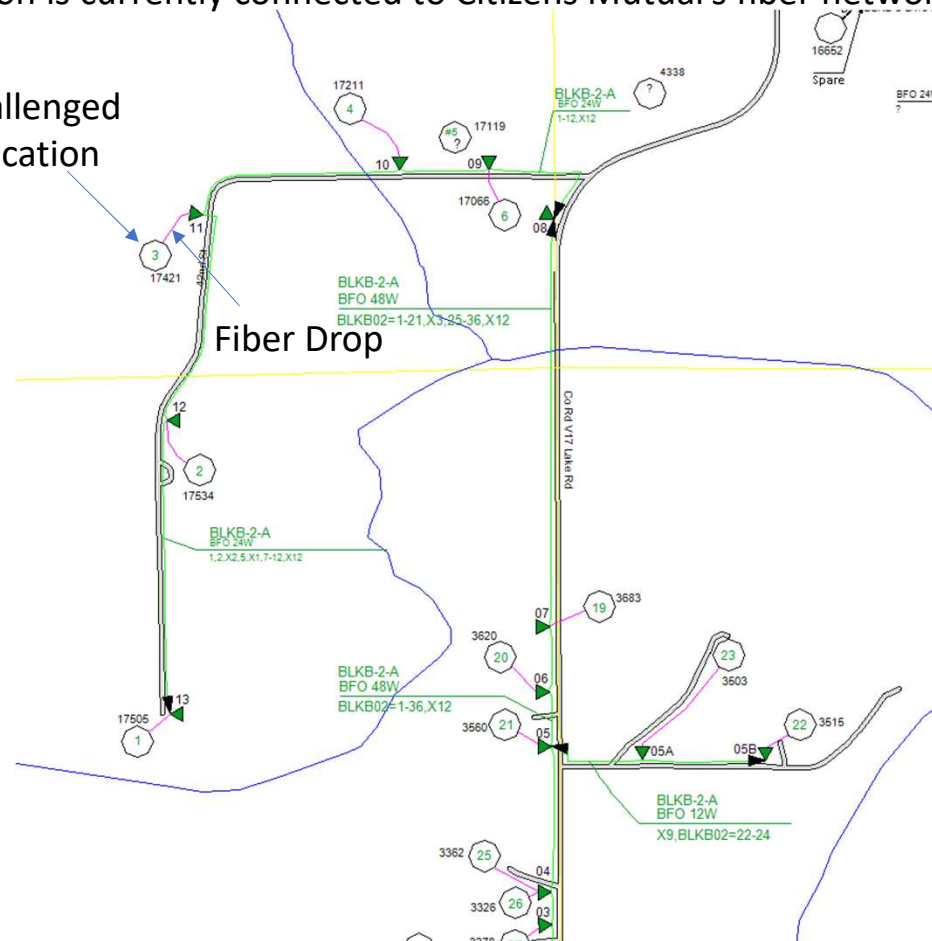

This location is currently connected to Citizens Mutual's fiber network.

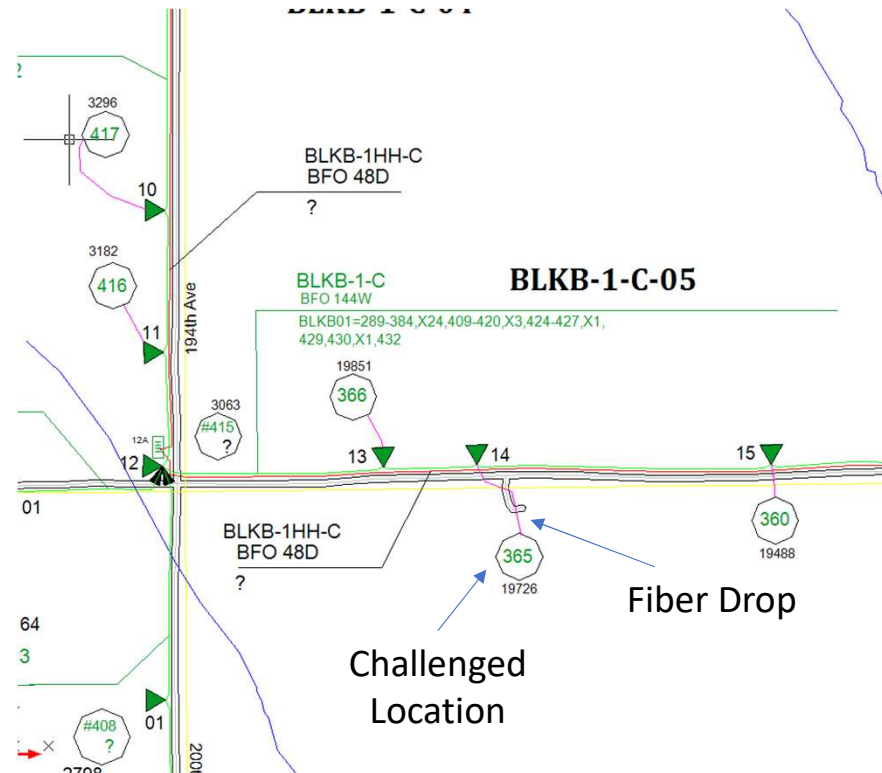

This location is within Citizen Mutual's service area. A drop cable would need to be placed to provide service and can be accomplished within 10 business days.

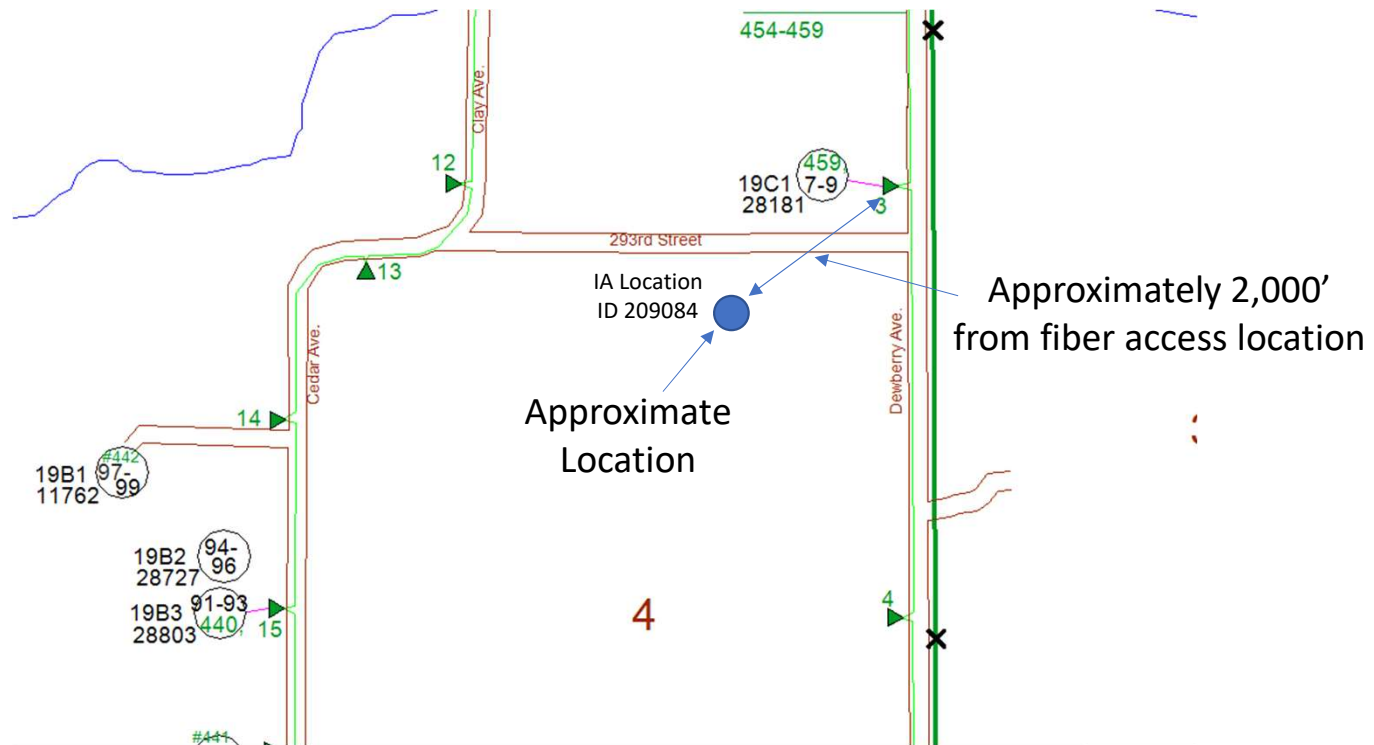

Approximately 250' from fiber access location

BLKB-1-C-07

BLKB-1-C  
BFO 24W  
X3,352-360,X12

BLKB-2-A1  
BFO 24W  
X2,39-42,X1,44-48,X12

BLKB-2-HHA1  
BFO 48D  
?

BLKB-2-A1  
BFO 12W  
37,38,X10

BFO 12W  
349-351,X9

IA Location  
ID 873754

Approximate  
Location

BLKB-1-C10-01



This location is within Citizen Mutual's service area. A drop cable would need to be placed to provide service and can be accomplished within 10 business days.

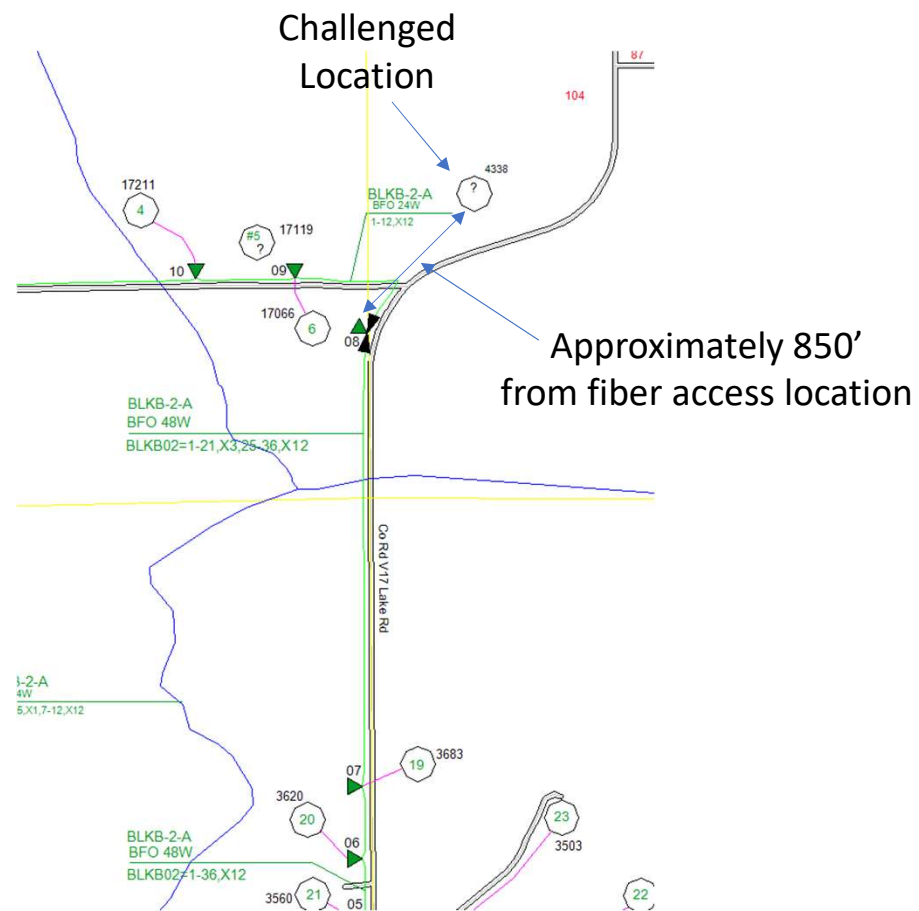



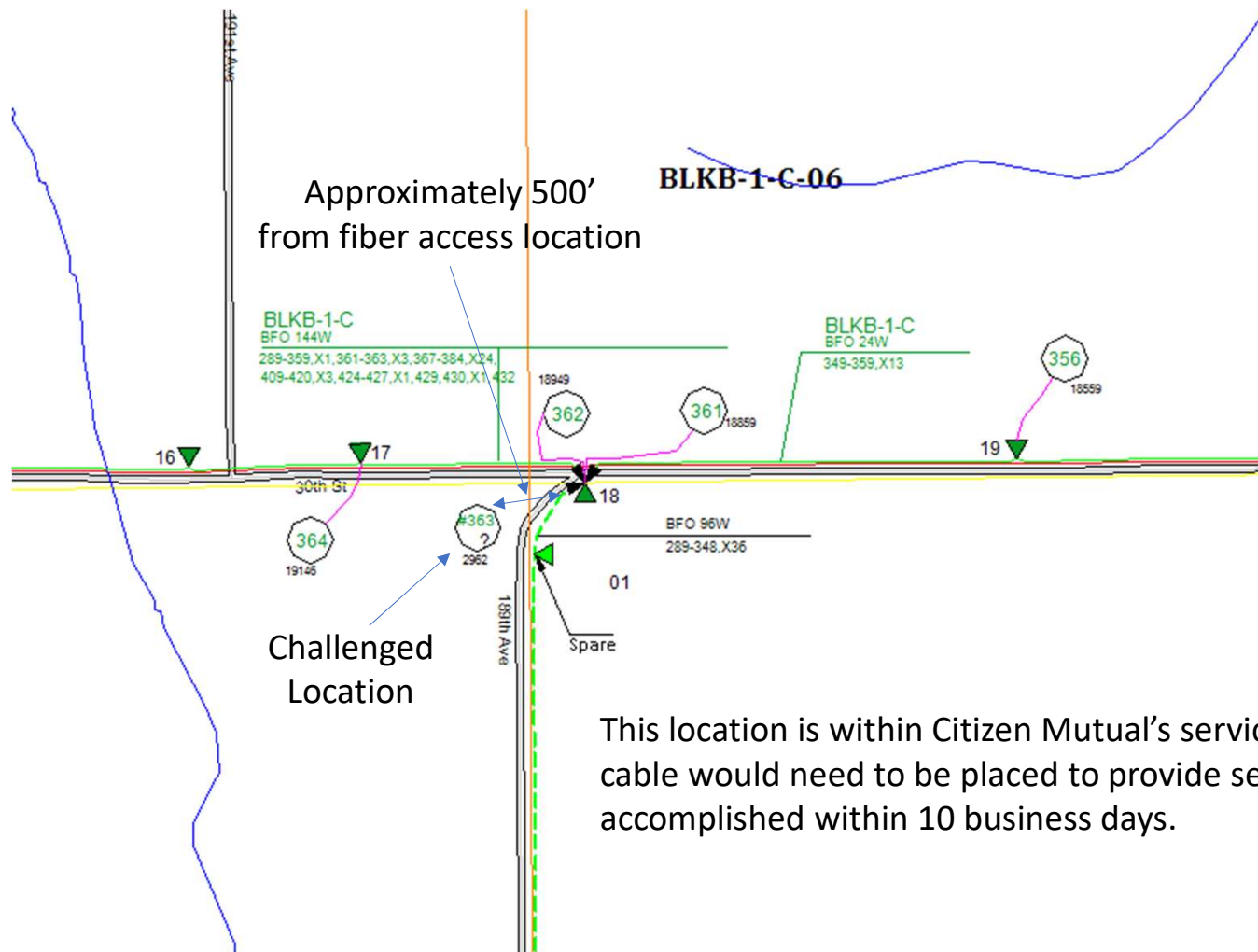

This location is within Citizen Mutual's service area. A drop cable would need to be placed to provide service and can be accomplished within 10 business days.

This location is within Citizen Mutual's service area. A drop cable would need to be placed to provide service and can be accomplished within 10 business days.

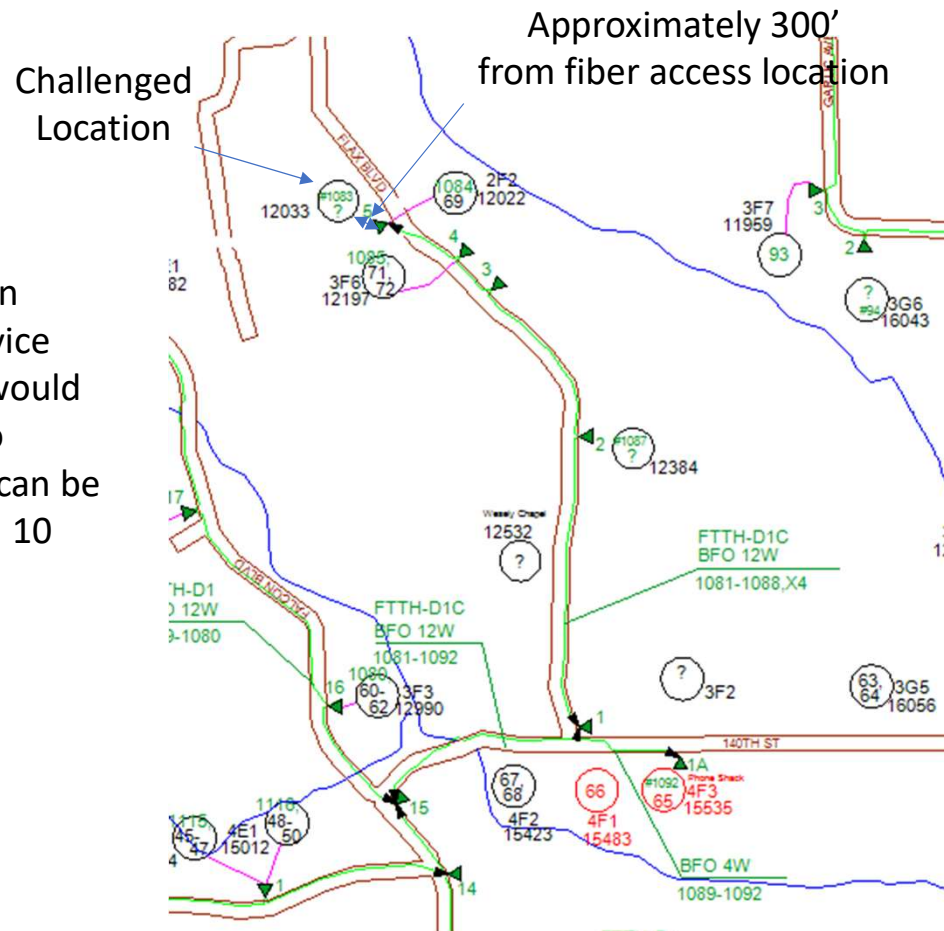

This location is within Citizen Mutual's service area. A drop cable would need to be placed to provide service and can be accomplished within 10 business days.

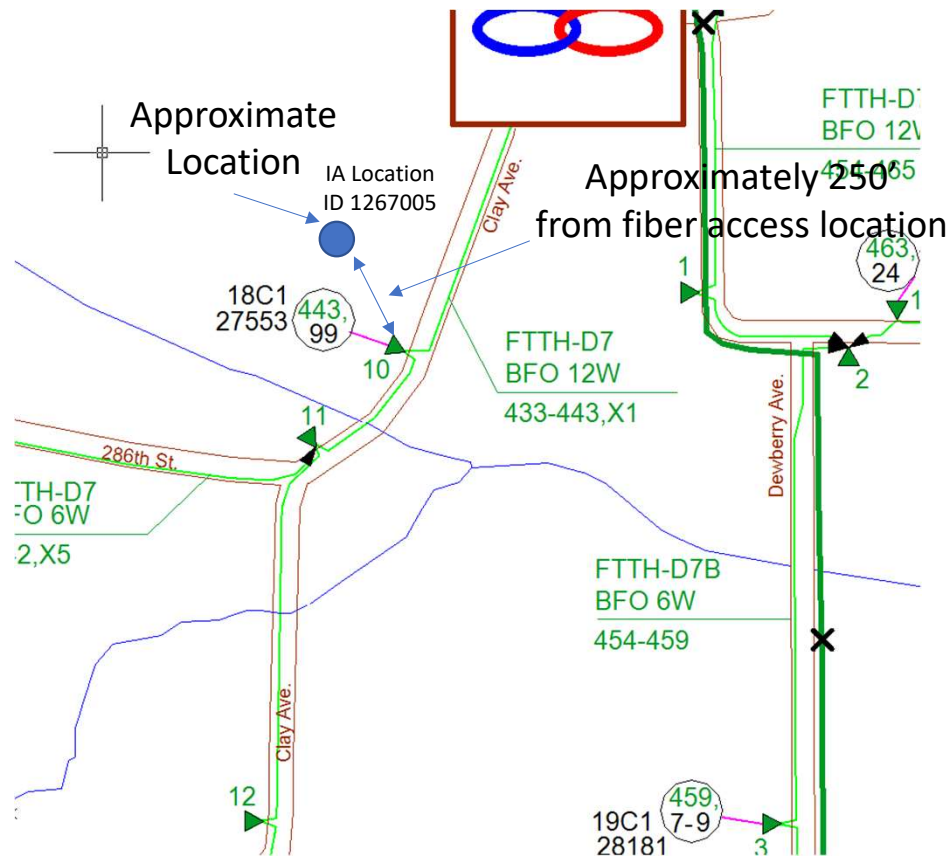

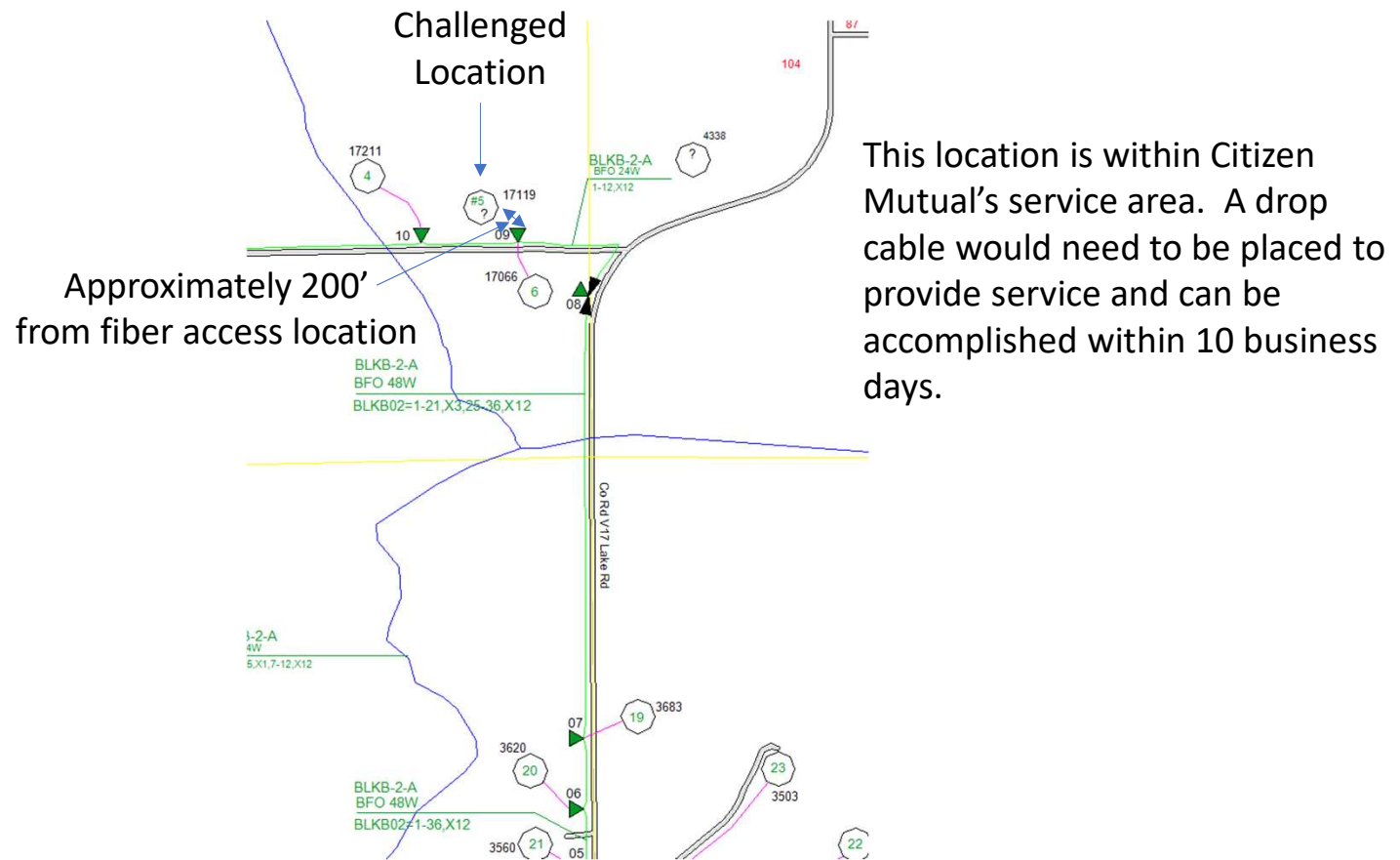

[illegible]

This location is within Citizen Mutual's service area. A drop cable would need to be placed to provide service and can be accomplished within 10 business days.

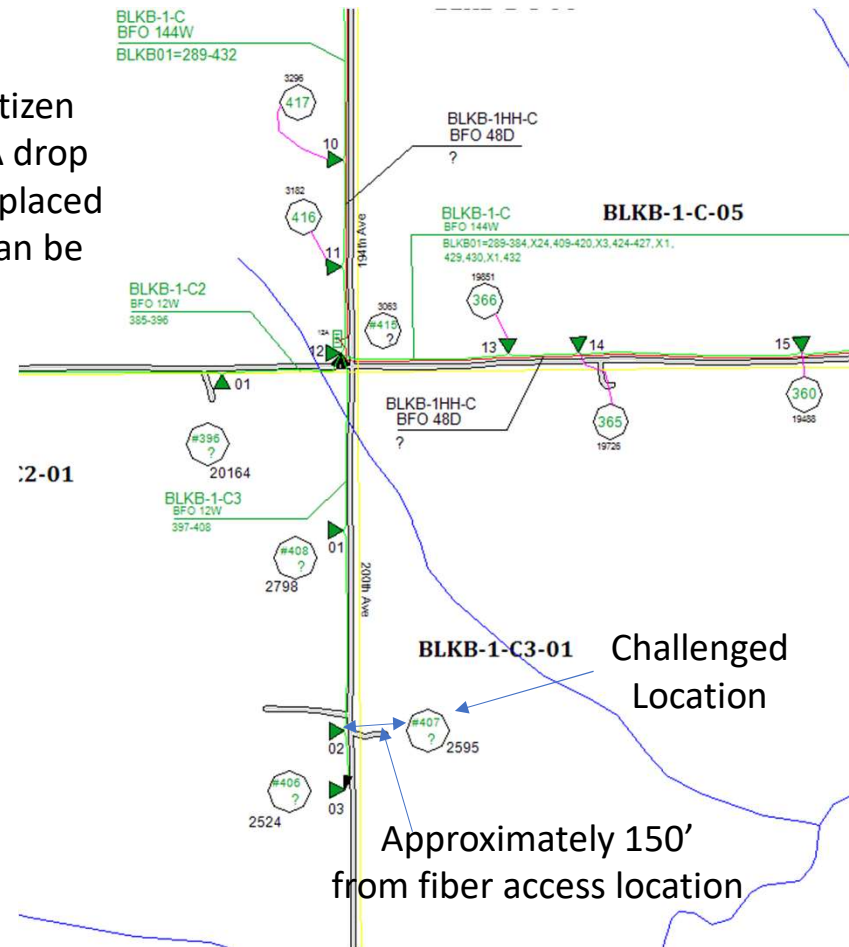



Approximately 150'  
from fiber access location

Challenged  
Location

**BLKB-1-C-05**

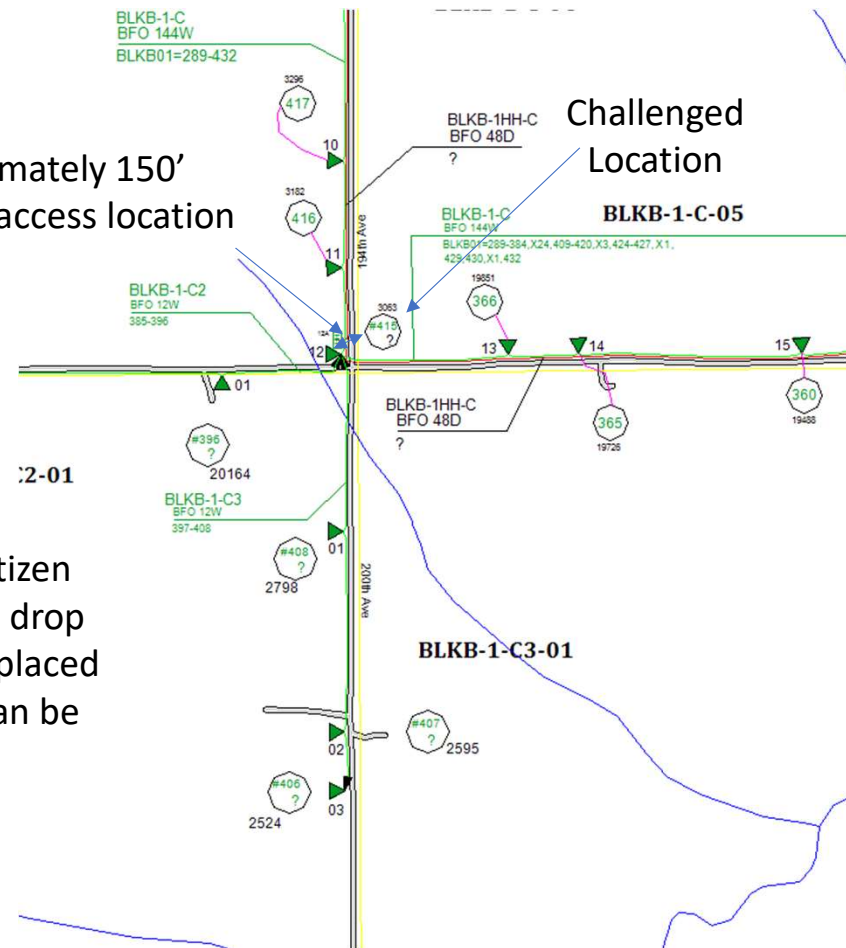

This location is within Citizen  
Mutual's service area. A drop  
cable would need to be placed  
to provide service and can be  
accomplished within 10  
business days.

This location is within Citizen Mutual's service area. A drop cable would need to be placed to provide service and can be accomplished within 10 business days.

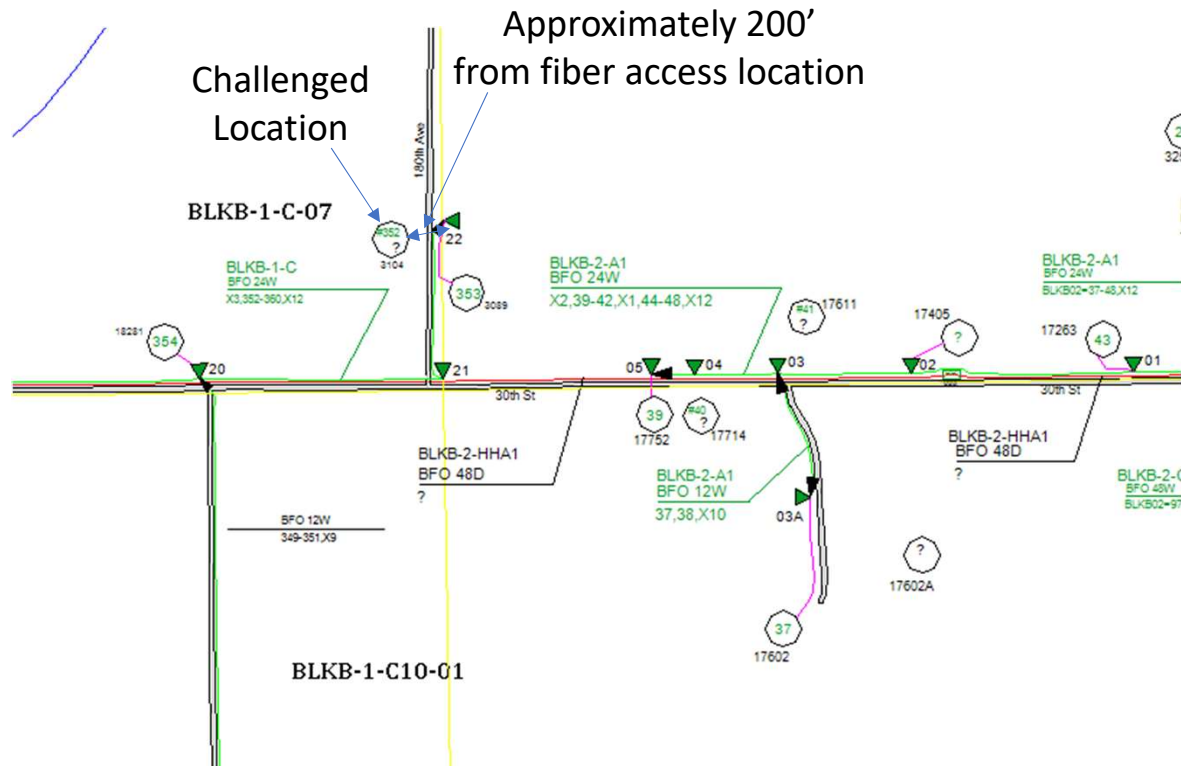

[illegible]

The rate/reach chart below is an independent representation of the downstream rates that can be achieved using the latest VDSL2 technology. This chart is produced by an independent organization, the Broadband Forum (BBF). As the chart indicates, without any impairments, the maximum distance that 307 mbps download can be achieved is approximately 1,100 feet (yellow highlight). The maximum distance for 100 mbps necessary to be considered likely served is approximately 2,700' (blue highlight) Citizens Mutual is not aware of fiber in this areas that would facilitate a DSL access node that would be within the physical limitations of VDSL2 to achieve these speeds.

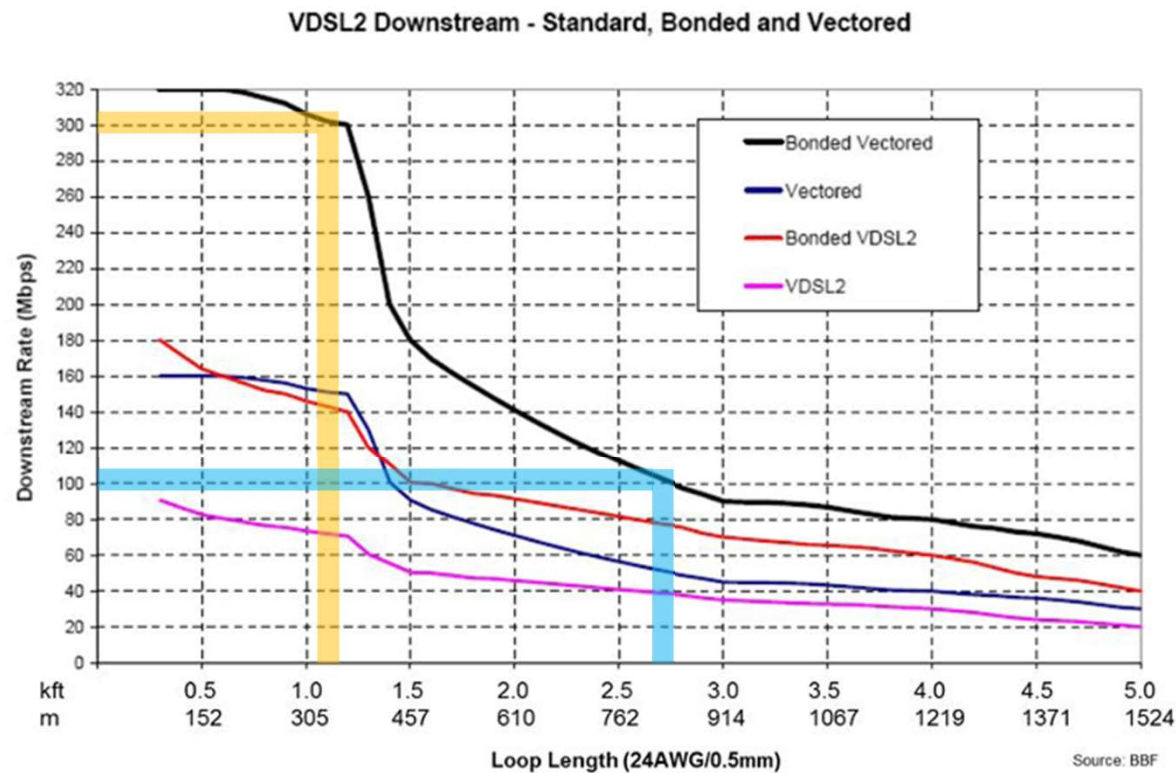

The rate/reach chart below is an independent representation of the downstream rates that can be achieved using the latest VDSL2 technology. This chart is produced by an independent organization, the Broadband Forum (BBF). As the chart indicates, without any impairments, the maximum distance that 252 mbps download can be achieved is approximately 1,300 feet (yellow highlight). The maximum distance for 100 mbps necessary to be considered likely served is approximately 2,700' (blue highlight) Citizens Mutual is not aware of fiber in this areas that would facilitate a DSL access node that would be within the physical limitations of VDSL2 to achieve these speeds.

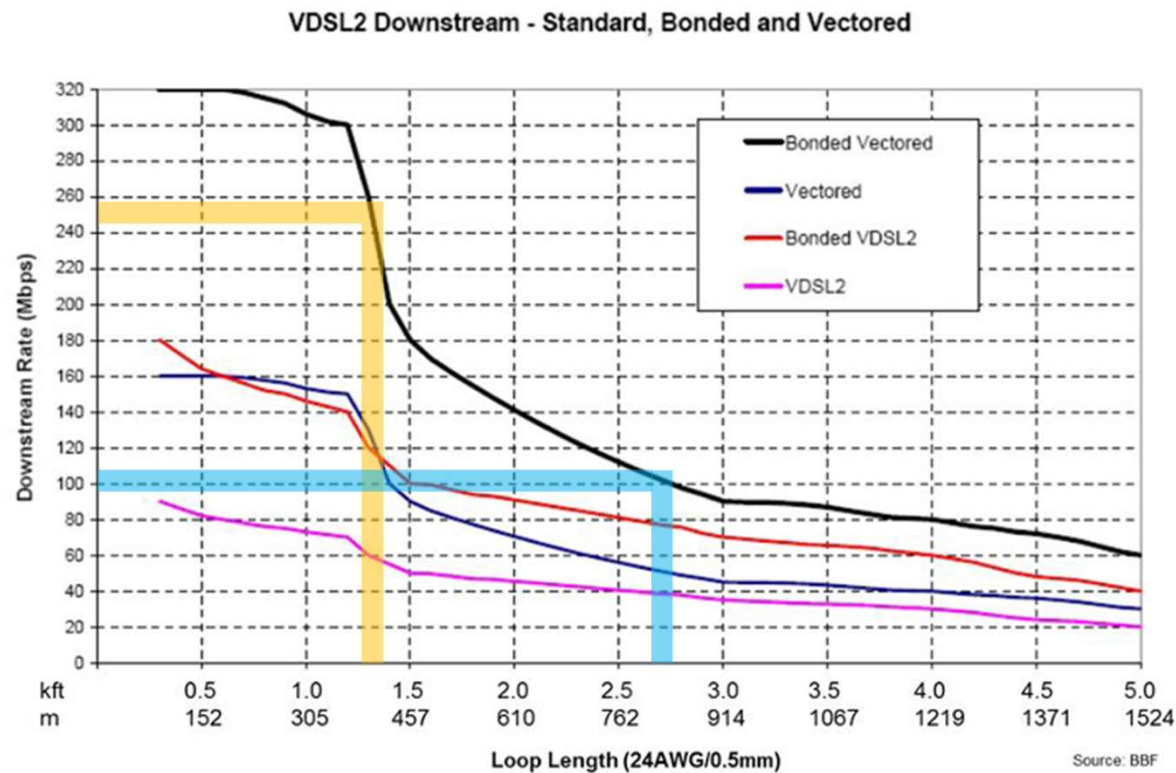

The rate/reach chart below is an independent representation of the downstream rates that can be achieved using the latest VDSL2 technology. This chart is produced by an independent organization, the Broadband Forum (BBF). As the chart indicates, without any impairments, the maximum distance that 200 - 209 mbps download can be achieved is approximately 1,400 feet (yellow highlight). The maximum distance for 100 mbps necessary to be considered likely served is approximately 2,700' (blue highlight) Citizens Mutual is not aware of fiber in this areas that would facilitate a DSL access node that would be within the physical limitations of VDSL2 to achieve these speeds.

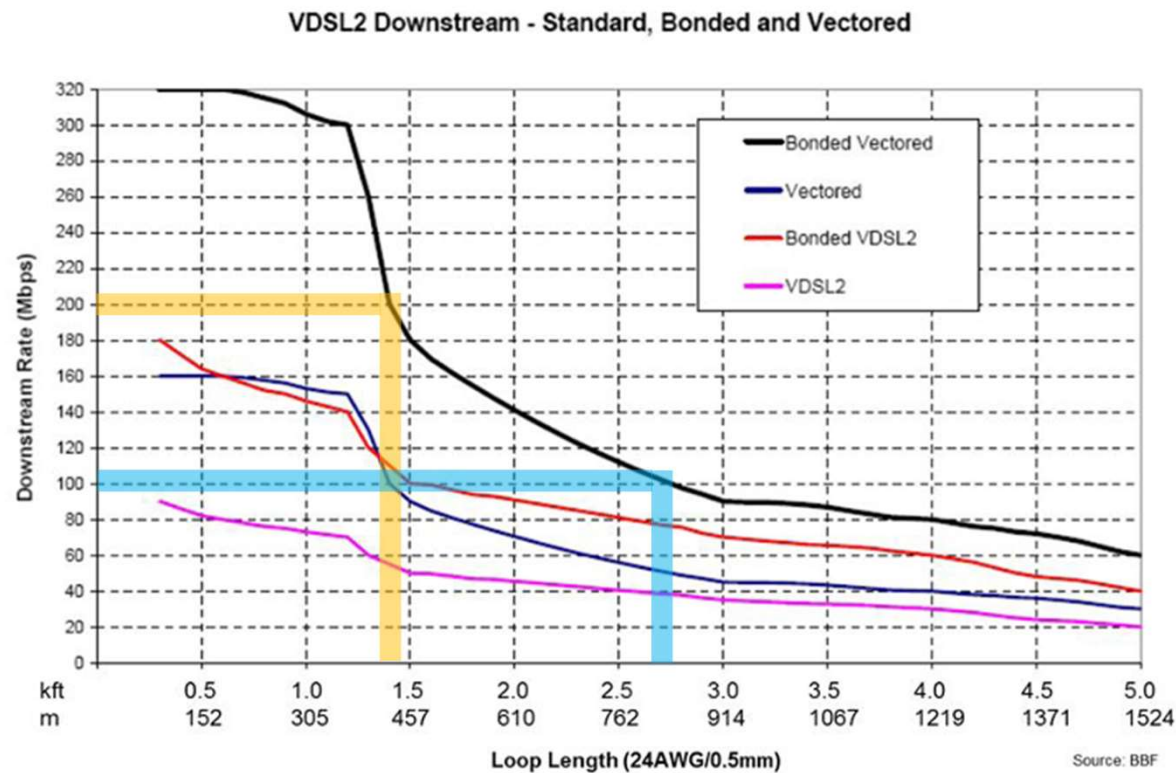

The rate/reach chart below is an independent representation of the downstream rates that can be achieved using the latest VDSL2 technology. This chart is produced by an independent organization, the Broadband Forum (BBF). As the chart indicates, without any impairments, the maximum distance that 180 - 184 mbps download can be achieved is approximately 1,500 feet (yellow highlight). The maximum distance for 100 mbps necessary to be considered likely served is approximately 2,700' (blue highlight) Citizens Mutual is not aware of fiber in this areas that would facilitate a DSL access node that would be within the physical limitations of VDSL2 to achieve these speeds.

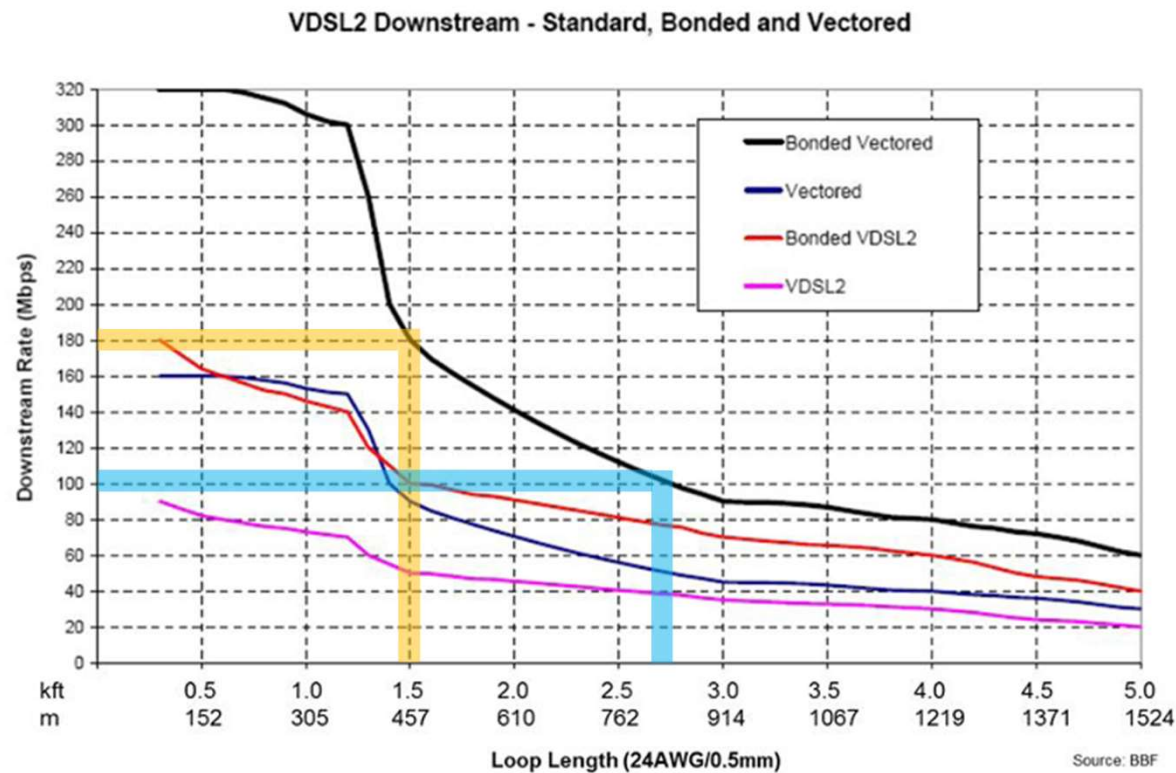



The rate/reach chart below is an independent representation of the downstream rates that can be achieved using the latest VDSL2 technology. This chart is produced by an independent organization, the Broadband Forum (BBF). As the chart indicates, without any impairments, the maximum distance that 160 mbps download can be achieved is approximately 1,700 feet (yellow highlight). The maximum distance for 100 mbps necessary to be considered likely served is approximately 2,700' (blue highlight) Citizens Mutual is not aware of fiber in this areas that would facilitate a DSL access node that would be within the physical limitations of VDSL2 to achieve these speeds.

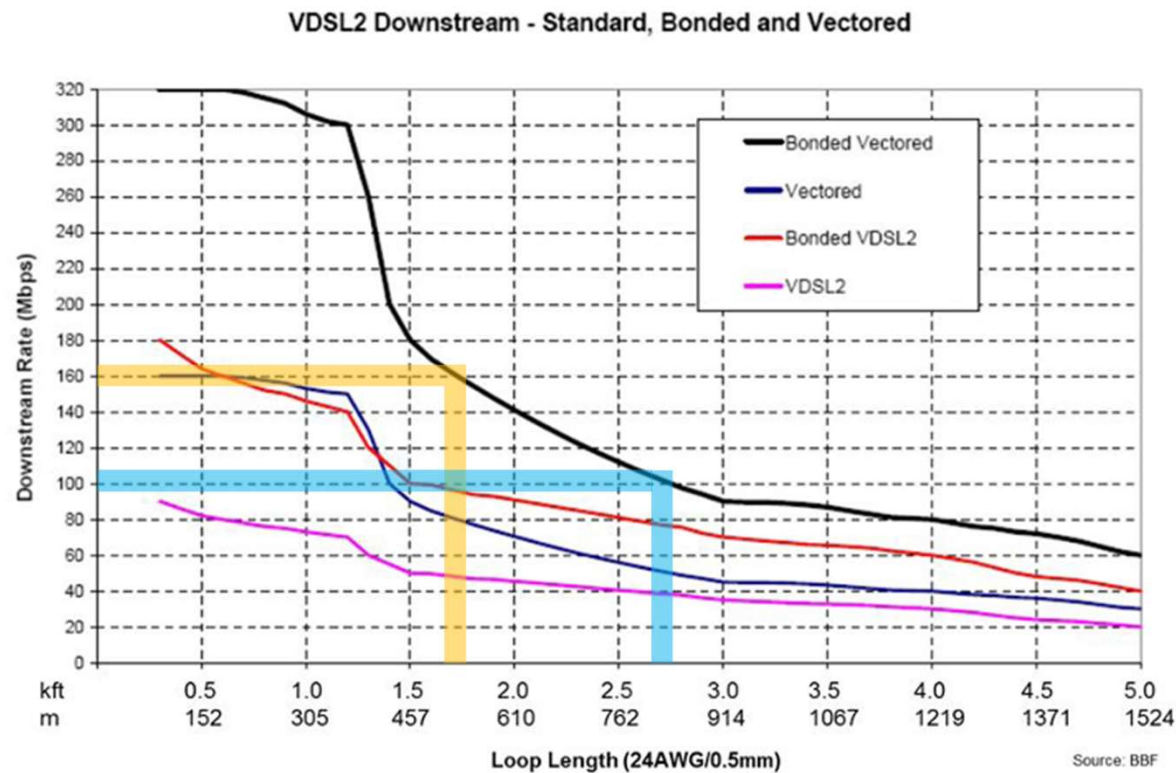



The rate/reach chart below is an independent representation of the downstream rates that can be achieved using the latest VDSL2 technology. This chart is produced by an independent organization, the Broadband Forum (BBF). As the chart indicates, without any impairments, the maximum distance that 123 mbps download can be achieved is approximately 2,300 feet (yellow highlight). The maximum distance for 100 mbps necessary to be considered likely served is approximately 2,700' (blue highlight) Citizens Mutual is not aware of fiber in this areas that would facilitate a DSL access node that would be within the physical limitations of VDSL2 to achieve these speeds.

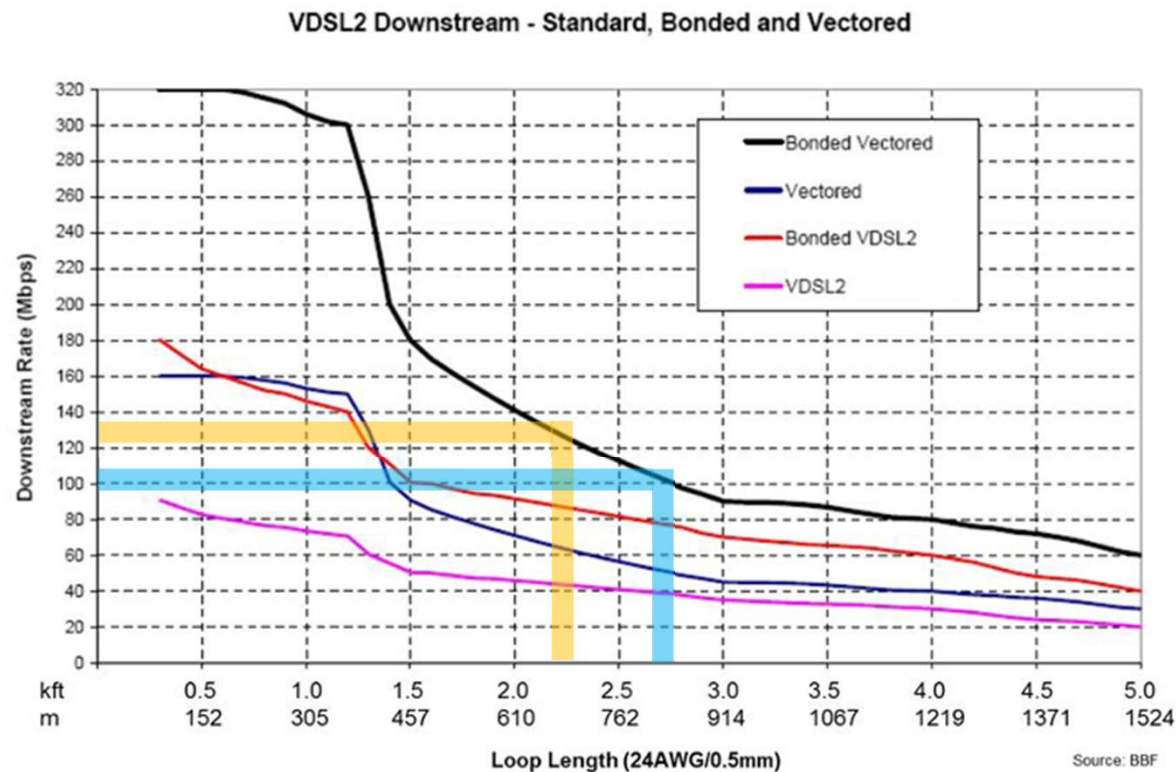

The rate/reach chart below is an independent representation of the downstream rates that can be achieved using the latest VDSL2 technology. This chart is produced by an independent organization, the Broadband Forum (BBF). As the chart indicates, without any impairments, the maximum distance that 111 mbps download can be achieved is approximately 2,300 feet (yellow highlight). The maximum distance for 100 mbps necessary to be considered likely served is approximately 2,700' (blue highlight) Citizens Mutual is not aware of fiber in this areas that would facilitate a DSL access node that would be within the physical limitations of VDSL2 to achieve these speeds.

